

Thank you for choosing Rosetta Hardscapes products. The following are some helpful tips to make your first installation go smoothly. For more in-depth technical information, see our Grand Ledge Installation Manual (available at [rosettahardscapes.com](http://rosettahardscapes.com)) or contact Rosetta Tech Support.

*Your safety is important to us. Please follow OSHA guidelines, and utilize safety-toe boots, hardhats, gloves and eye, ear & respiratory protection whenever appropriate.*

### BLEND MULTIPLE PALLETS

- In order to achieve the best possible color blend, utilize material from multiple pallets simultaneously (when applicable).

### SHEAR HEEL REMOVAL (BASE ROW)

- Using a sledgehammer, knock the shear heels off the blocks to be used on the base row. This will make leveling the base row easier.

### BASE ROW

- When setting the base course, align the blocks at the mold line - the line between the face texture and the back of the block. After setting each block, double-check for level both front to back and side to side.
- The more precisely the bottom row is placed, the easier the subsequent rows will install.

### BACKFILL EACH ROW

- Always backfill the wall as you go. Stacking blocks without backfill could result in the wall falling over.

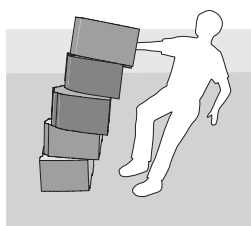

### INSTALLATION GUIDELINES

- Follow all guidelines set forth in the Grand Ledge Installation Manual. Improper installation practices can result in wall failure.

## REQUIRED TOOLS

- HEAVY CONSTRUCTION VEHICLE (RATED TO SAFELY LIFT 2,000 LBS.)
- CHAIN (RATED TO SAFELY LIFT 2,000 LBS.)
- ROSETTA LIFTING DEVICE
- GRAND LEDGE INSTALLATION MANUAL
- PLATE COMPACTOR
- SHOVEL
- RAKE
- LEVEL
- SLEDGEHAMMER
- STRING-LINE

### OPTIONAL TOOLS:

- TRANSIT LEVEL
- PINCH POINT BAR
- CUT OFF SAW

### OTHER:

- NON-WOVEN GEOTEXTILE FABRIC
- 4" PERFORATED DRAIN PIPE
- GEOGRID (REINFORCED ONLY)

# GRAND LEDGE

## QUICK INSTALL TIPS

For reference only. Refer to Grand Ledge Installation Manual for detailed instructions. Final designs must be prepared by a professional engineer.

### TYPICAL GRAVITY WALL SECTION (GENERALLY 0-6 FT. TALL)

**PRELIMINARY  
NOT FOR  
CONSTRUCTION**

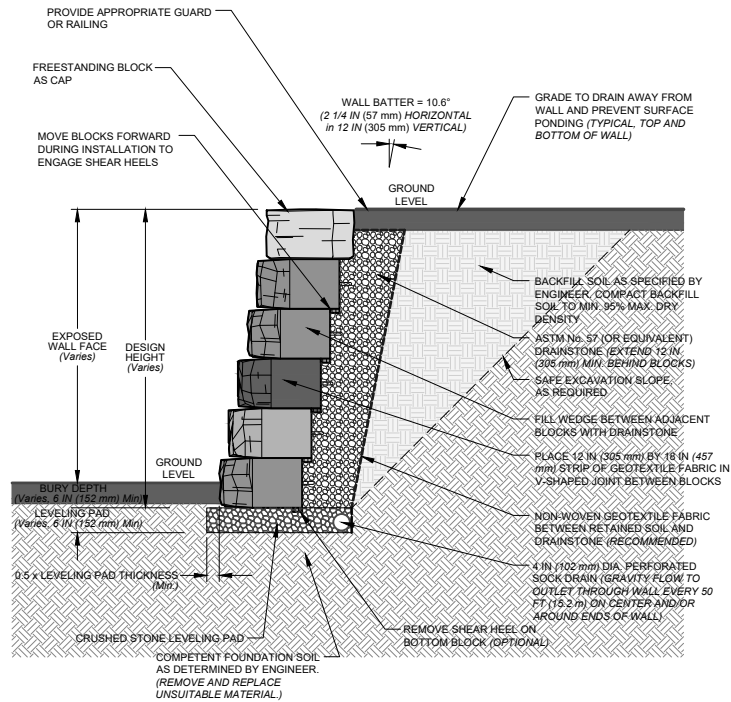

### TYPICAL REINFORCED WALL SECTION (GENERALLY 4 FT. AND TALLER)

**PRELIMINARY  
NOT FOR  
CONSTRUCTION**

