

GEOGRID LAYOUT FOR 90° OUTSIDE CORNER

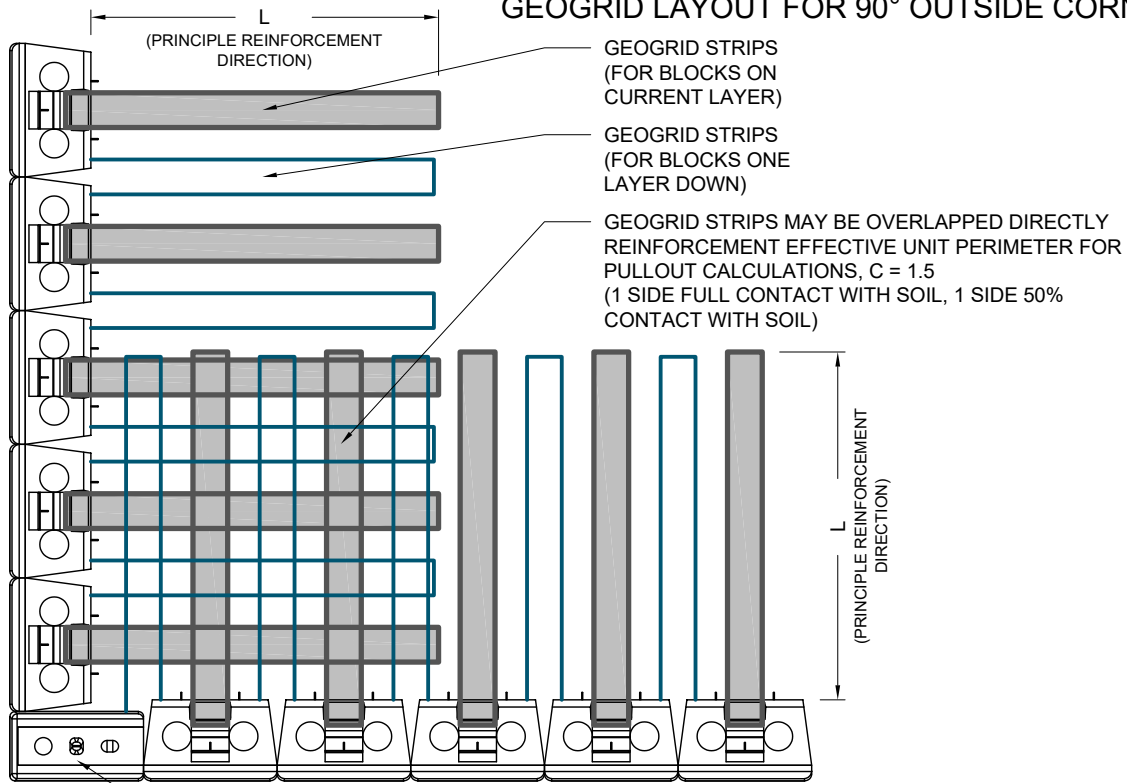

GEOGRID STRIPS ARE NOT CONNECTED TO FREESTANDING CORNER BLOCK. INTERFACE SHEAR TRANSFER BETWEEN PC AND CORNER BLOCKS SECURE CORNER BLOCK IN PLACE. REINFORCEMENT COVERAGE = 25% AT CORNER BLOCK.

BLOCK LAYOUT FOR 90° OUTSIDE CORNER

THE TOP ROW OF BLOCKS ARE SHOWN IN RED. THEY HAVE BEEN CUTOUT IN LINE WITH THEIR BOTTOM GROOVES TO SHOW HOW THEY FIT WITH THE KNOBS ON THE BOTTOM ROW OF BLOCK.

THE GEOGRID STRIPS ARE NOT SHOWN FOR CLARITY.

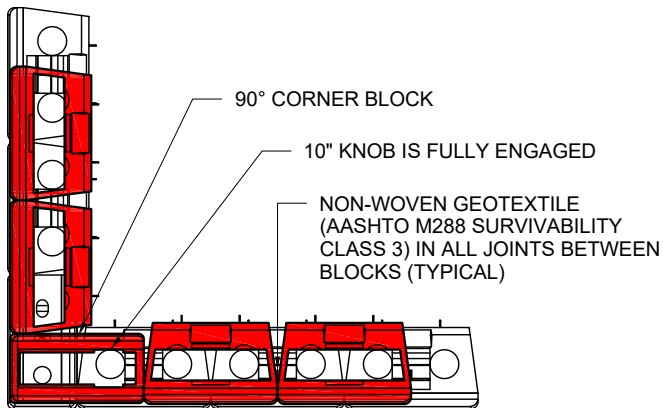

TOP VIEW OF CORNER

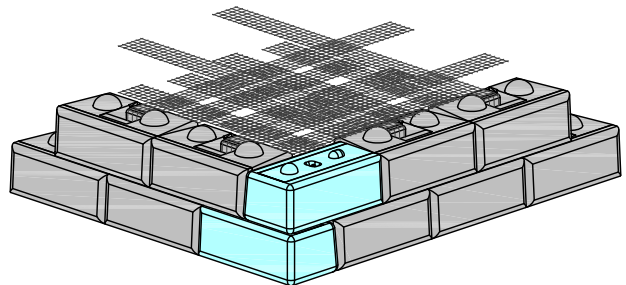

3D VIEW OF CORNER

Copyright 2015 Redi-Rock International. All rights reserved.
 Determination of the suitability and/or manner of use of any details contained in this document is the sole responsibility of the design engineer of record.
 Final project designs, including all construction details, shall be prepared by a licensed professional engineer.

DRAWN BY:	J. JOHNSON
APPROVED BY:	J. JOHNSON
DATE:	JAN. 28, 2015
SHEET:	1 of 1

TITLE:	GEOGRID LAYOUT FOR 90° OUTSIDE CORNER <i>REDI-ROCK PC SYSTEM</i>
FILE:	Geogrid Layout for Outside 90 Corner PC 012815.dwg



05481 US 31 SOUTH, CHARLEVOIX, MI 49720
 (866) 222-8400 ext 3010 • www.redi-rock.com