



BLOCK LIBRARY

One System, Four Textures, Endless Solutions

The Redi-Rock system is robust, and each of the components can be seamlessly integrated into a cohesive retaining wall design. With the ability to get any block in the Redi-Rock arsenal in four, natural stone textures, it means that technical agility comes with just the right aesthetic touch.

Each local manufacturer produces Redi-Rock in colors that match their natural terrain using molds crafted from real stone and first-use, architectural-grade, precast concrete. That means Redi-Rock walls have detail, durability, and design power—a combination that's hard to come by.

Check out the faces of
Redi-Rock's endless solutions:
LEDGESTONE, COBBLESTONE,
LIMESTONE, AND KINGSTONE.



LEDGESTONE

The rugged relief of Ledgestone blocks give projects a random, stacked stone appearance. With up to 115 square feet (10.5 square meters) of non-repeating texture, it'll be tough to tell all that large block power is behind that pretty face. It's a win-win.



COBBLESTONE

When it comes to classic good looks, Cobblestone is where it's at. Each one-ton block features the appearance of six smaller blocks, creating a timeless aesthetic. Sometimes, the linear appeal of a smaller stacked stone provides the enduring impact you're looking for in a wall.



LIMESTONE

The six square feet (0.5 square meters) of face per Limestone block leaves a large, lasting impression. Crafted from real split limestone, the quarried stone texture means there's no need to sacrifice on style for function—you can get both at a grand scale!



KINGSTONE

Striking a balance between the grandiose scale of Limestone and rugged relief of Ledgestone, Kingstone appears weathered by water and time like the crown of a natural stone outcropping. With each Redi-Rock block looking like a large, quarried stone, Kingstone will transform retaining walls into castle-worthy walls.



Ledgestone



Cobblestone



Limestone



Kingstone

RETAINING BLOCKS
(FINISHED TEXTURE ON ONE FACE)

The Redi-Rock Retaining wall blocks come in multiple widths and configurations. The defining characteristic is that Retaining blocks have an aesthetic texture cast into only ONE face, and the textured face is the only side exposed to view in the finished wall. These blocks are machine-placed, wet-cast, precast modular block units manufactured from first purpose, non-reconstituted concrete and intended for constructing dry-stacked modular retaining wall systems. The block units are manufactured from structural-grade concrete mixes in accordance with ASTM C94 or ASTM C685 that produce a finished unit with excellent resistance to freeze-thaw, deicing chemical exposure, and submerged conditions in both fresh water and salt water applications. All Redi-Rock blocks are manufactured and distributed through an international network of individually-owned, licensed precast concrete manufacturers.

CONCRETE MIX PROPERTIES ⁽¹⁾

FREEZE THAW EXPOSURE CLASS ⁽²⁾	MINIMUM 28 DAY COMPRESSIVE STRENGTH ⁽³⁾	MAXIMUM WATER CEMENT RATIO	NOMINAL MAXIMUM AGGREGATE SIZE ⁽¹⁰⁾	AGGREGATE CLASS DESIGNATION ⁽⁴⁾	AIR CONTENT ⁽⁵⁾
MODERATE	4,000 psi (27.6 MPa)	0.45	1.0 (25)	3M	4.5% ± 1.5%
SEVERE	4,000 psi (27.6 MPa)	0.45	1.0 (25)	3S	6.0% ± 1.5%
VERY SEVERE	4,500 psi (30.0 MPa)	0.40	1.0 (25)	4S	6.0% ± 1.5%
MAXIMUM WATER-SOLUBLE CHLORIDE ION (Cl ⁻) CONTENT IN CONCRETE, PERCENT BY WEIGHT OF CEMENT ^(6,7)					0.15
MAXIMUM CHLORIDE AS Cl ⁻ CONCENTRATION IN MIXING WATER, PARTS PER MILLION					1000
MAXIMUM PERCENTAGE OF TOTAL CEMENTITIOUS MATERIALS BY WEIGHT ^(8,10) (VERY SEVERE EXPOSURE CLASS ONLY)					
FLY ASH OR OTHER POZZOLANS PER ASTM C618		25	TOTAL ASH, POZZOLANS, SLAG, AND SILICA FUME ⁽⁹⁾		50
SLAG CONFORMING TO ASTM C989		50	TOTAL ASH, POZZOLANS, AND SILICA FUME ⁽⁹⁾		35
SILICA FUME CONFORMING TO ASTM C1240		10	ALKALI-AGGREGATE REACTIVITY MITIGATION PER ACI 201		

REFERENCE DIMENSIONS:

HEIGHT = VERTICAL DIMENSION OF TEXTURED FACE
LENGTH = HORIZONTAL DIMENSION PARALLEL TO TEXTURED FACE
WIDTH = HORIZONTAL DIMENSION PERPENDICULAR TO TEXTURED FACE

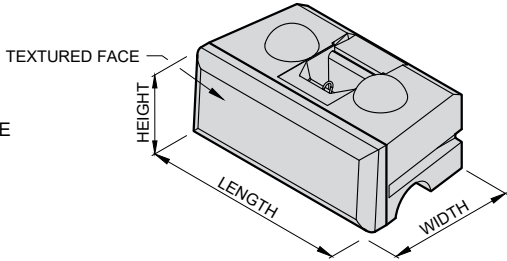

DIMENSIONAL TOLERANCES ^{(11) (12)}

HEIGHT	ALL BLOCKS	18 ± 3⁄₁₆ (457 ± 5) or 36 ± 3⁄₁₆ (914 ± 5)
LENGTH	FULL BLOCKS	46 1⁄₈ ± 1⁄₂ (1172 ± 13)
	HALF BLOCKS	22 13⁄₁₆ ± 1⁄₂ (579 ± 13)
WIDTH	28" (710) BLOCKS	22 5⁄₈ ± 1⁄₂ (575 ± 13) FORM LINE TO BACK OF BLOCK, PLUS APPROXIMATELY 5⁄₈ (136) FACE TEXTURE
	41" (1030) BLOCKS	35 1⁄₈ ± 1⁄₂ (892 ± 13) FORM LINE TO BACK OF BLOCK, PLUS APPROXIMATELY 5⁄₈ (136) FACE TEXTURE
	60" (1520) BLOCKS	54 5⁄₈ ± 1⁄₂ (1387 ± 13) FORM LINE TO BACK OF BLOCK, PLUS APPROXIMATELY 5⁄₈ (136) FACE TEXTURE
	52" (1320) XL BLOCKS	46 5⁄₈ ± 1⁄₂ (1184 ± 13) FORM LINE TO BACK OF BLOCK, PLUS APPROXIMATELY 5⁄₈ (136) FACE TEXTURE
	72" (1830) XL BLOCKS	66 5⁄₈ ± 1⁄₂ (1692 ± 13) FORM LINE TO BACK OF BLOCK, PLUS APPROXIMATELY 5⁄₈ (136) FACE TEXTURE
	96" (2440) XL BLOCKS	90 5⁄₈ ± 1⁄₂ (2302 ± 13) FORM LINE TO BACK OF BLOCK, PLUS APPROXIMATELY 5⁄₈ (136) FACE TEXTURE

⁽¹⁾ Concrete mix properties are in general accordance with ACI 318 durability requirements. Research has shown that concrete manufactured to these standards demonstrates good durability and performance. When these requirements are followed, specific freeze-thaw testing of the concrete is typically NOT required.

⁽²⁾ Exposure class is as described in ACI 318.

⁽³⁾ Test method ASTM C39.

⁽⁴⁾ Defined in ASTM C33 Table 3 *Limits for Deleterious Substances and Physical Property Requirements of Coarse Aggregate for Concrete*.

⁽⁵⁾ Test method ASTM C231.

⁽⁶⁾ Test method ASTM C1218 at age between 28 and 42 days.

⁽⁷⁾ Where used in high sulfate environments or where alkali-silica reactivity is and issue, watesoluble chloride shall be limited to no more than trace amounts (from impurities in concrete-making components, not intended constituents.)

⁽⁸⁾ The total cementitious material also includes ASTM C150, C595, C845, and C1157 cement. The maximum percentages shall include:

(a) Fly ash or other pozzolans in type IP, blended cement, ASTM C595, or ASTM C1157.

(b) Slag used in the manufacture of an IS blended cement, ASTM C595, or ASTM C1157.

(c) Silica fume, ASTM C1240, present in a blended cement.

⁽⁹⁾ Fly ash or other pozzolans and silica fume shall constitute no more than 25 and 10 percent, respectively, of the total weight of the cementitious materials.

⁽¹⁰⁾ Prescriptive limits shown may be waived for concrete mixes that demonstrate excellent freeze-thaw durability in a detailed and current testing program.

⁽¹¹⁾ All dimensions are shown in units of *inches (mm)*.

⁽¹²⁾ Permissible defects: Chips smaller than 1.5" (38mm) in its largest dimension and cracks not wider than 0.012" (0.305mm) and not longer than 25% of the nominal height of the block; bug holes in the architectural face smaller than 0.75" (19mm); and bug holes, water marks, and color variation on non-architectural faces.

RETAINING BLOCKS

Block Library

R-28T 28" (710mm) TOP	R-28HT 28" (710mm) HALF TOP
Face Texture: Cobble / Limestone Kingstone / Ledgestone	Face Texture: Cobble / Limestone Kingstone / Ledgestone
Block Weight: 1230 lb (557 kg) 1160 lb (530 kg)	Block Weight: 570 lb (260 kg) 540 lb (240 kg)
Block Volume: 8.57 ft³ (0.243 m³) 8.07 ft³ (0.229 m³)	Block Volume: 4.01 ft³ (0.113 m³) 3.76 ft³ (0.106 m³)
Center of Gravity: 14.9" (378mm) 14.2" (362mm)	Center of Gravity: 15.3" (389 mm) 14.7" (373 mm)

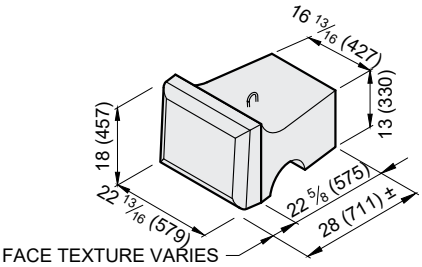
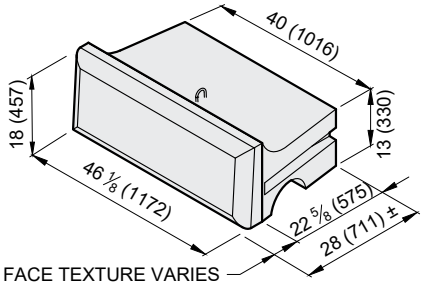

R-28M 28" (710mm) MIDDLE	R-28HM 28" (710mm) HALF MIDDLE
Face Texture: Cobble / Limestone Kingstone / Ledgestone	Face Texture: Cobble / Limestone Kingstone / Ledgestone
Block Weight: 1610 lb (730 kg) 1540 lb (700 kg)	Block Weight: 750 lb (340 kg) 710 lb (320 kg)
Block Volume: 11.28 ft³ (0.319 m³) 10.78 ft³ (0.305 m³)	Block Volume: 5.23 ft³ (0.148 m³) 4.98 ft³ (0.141 m³)
Center of Gravity: 13.9" (354 mm) 13.4" (340 mm)	Center of Gravity: 14.3" (364 mm) 13.8" (350 mm)

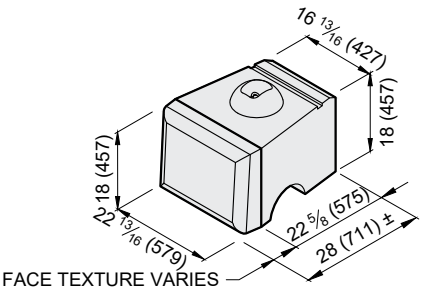
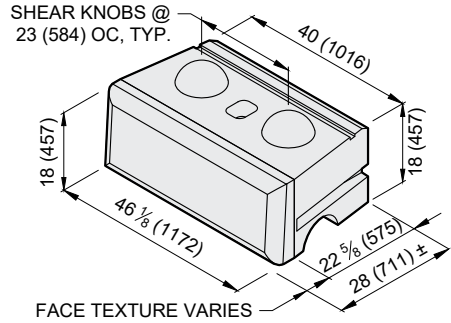

R-28B 28" (710mm) BOTTOM	R-28HB 28" (710mm) HALF BOTTOM
Face Texture: Cobble / Limestone Kingstone / Ledgestone	Face Texture: Cobble / Limestone Kingstone / Ledgestone
Block Weight: 1740 lb (790 kg) 1670 lb (760 kg)	Block Weight: 810 lb (370 kg) 770 lb (350 kg)
Block Volume: 12.19 ft³ (0.345 m³) 11.70 ft³ (0.331 m³)	Block Volume: 5.66 ft³ (0.160 m³) 5.41 ft³ (0.153 m³)
Center of Gravity: 14.0" (355 mm) 13.5" (343 mm)	Center of Gravity: 14.3" (364 mm) 13.8" (352 mm)

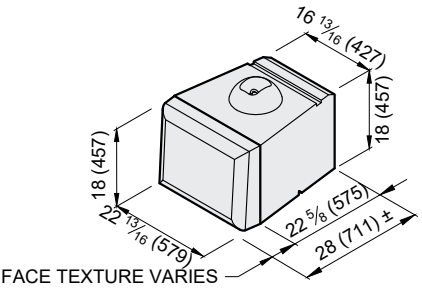
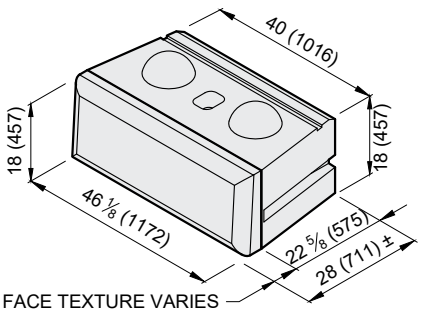

- Units for dimensions are inches (mm), typical unless noted otherwise.
 - Block production varies with each licensed Redi-Rock manufacturer. Confirm availability before Specifying or Ordering.
 - Center of Gravity is measured from the back of block.
 - Actual block volumes and weights may vary.
- Weights are based upon a concrete density of 143 lb/ft³ (2291kg/m³).
 - Half blocks contain a fork slot on only one side of the block.
 - Interface Shear knobs are typically 10" (254mm) diameter by 4" (102mm) tall. Smaller knob diameters are available.

RETAINING BLOCKS

Block Library

R-41T 41" (1030mm) TOP *			R-41HT 41" (1030mm) HALF TOP *		
Face Texture:	Cobble / Limestone	Kingstone / Ledgestone	Face Texture:	Cobble / Limestone	Kingstone / Ledgestone
Block Weight:	1750 lb (790 kg)	1680 lb (760 kg)	Block Weight:	770 lb (350 kg)	740 lb (330 kg)
Block Volume:	12.22 ft³ (0.346 m³)	11.73 ft³ (0.332 m³)	Block Volume:	5.38 ft³ (0.15 m³)	5.14 ft³ (0.15 m³)
Center of Gravity:	21.3" (540 mm)	20.6" (522 mm)	Center of Gravity:	22.4" (568 mm)	21.6" (550 mm)

SPECIALITY BLOCK

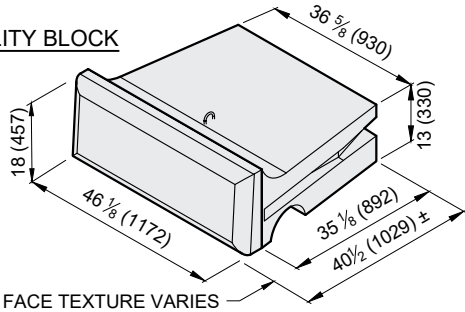

SPECIALITY BLOCK

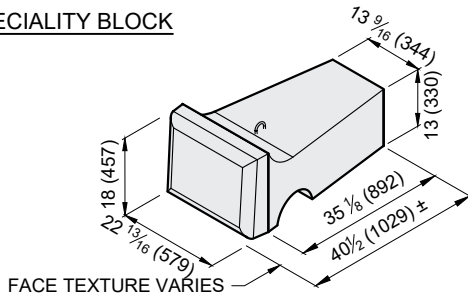

R-41M 41" (1030mm) MIDDLE			R-41HM 41" (1030mm) HALF MIDDLE		
Face Texture:	Cobble / Limestone	Kingstone / Ledgestone	Face Texture:	Cobble / Limestone	Kingstone / Ledgestone
Block Weight:	2310 lb (1050 kg)	2240 lb (1020 kg)	Block Weight:	1020 lb (460 kg)	990 lb (450 kg)
Block Volume:	16.14 ft³ (0.457 m³)	15.65 ft³ (0.443 m³)	Block Volume:	7.14 ft³ (0.20 m³)	6.90 ft³ (0.20 m³)
Center of Gravity:	20.4" (518 mm)	19.8" (504 mm)	Center of Gravity:	21.4" (543 mm)	20.8" (528 mm)

SHEAR KNOBS @ 23 (584) OC, TYP.

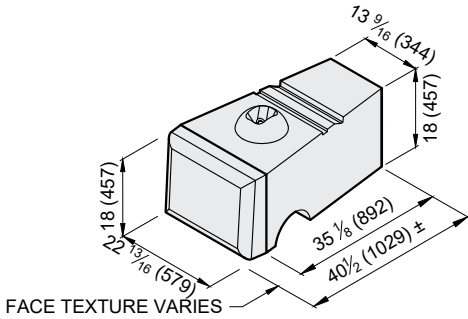
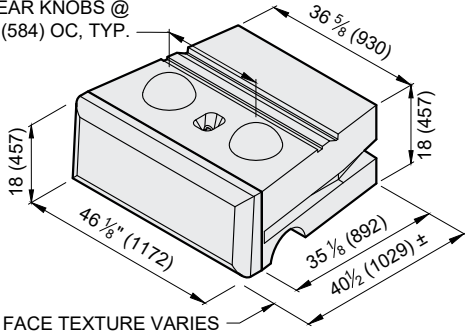

R-41B 41" (1030mm) BOTTOM			R-41HB 41" (1030mm) HALF BOTTOM		
Face Texture:	Cobble / Limestone	Kingstone / Ledgestone	Face Texture:	Cobble / Limestone	Kingstone / Ledgestone
Block Weight:	2440 lb (1110 kg)	2370 lb (1070 kg)	Block Weight:	1080 lb (490 kg)	1050 lb (480 kg)
Block Volume:	17.06 ft³ (0.483 m³)	16.56 ft³ (0.469 m³)	Block Volume:	7.58 ft³ (0.21 m³)	7.33 ft³ (0.21 m³)
Center of Gravity:	20.7" (527 mm)	20.2" (514 mm)	Center of Gravity:	21.7" (551 mm)	21.2" (538 mm)

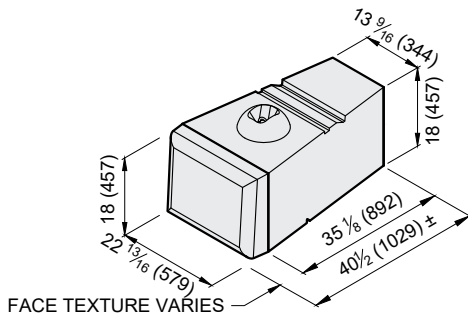
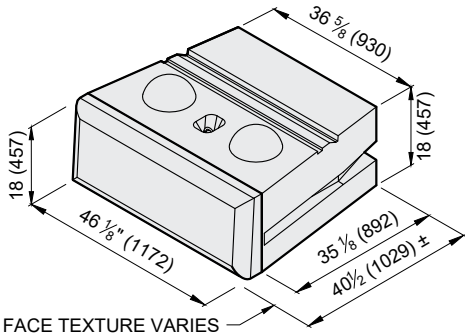

- Units for dimensions are inches (mm), typical unless noted otherwise.
- Block production varies with each licensed Redi-Rock manufacturer. Confirm availability before Specifying or Ordering.
- Center of Gravity is measured from the back of block.
- Actual block volumes and weights may vary.

- Weights are based upon a concrete density of 143 lb/ft³ (2291kg/m³).
- Half blocks contain a fork slot on only one side of the block.
- Interface Shear knobs are typically 10" (254mm) diameter by 4" (102mm) tall. Smaller knob diameters are available.
- * 41" (1030mm) Top blocks are not typical and used in limited applications.

RETAINING BLOCKS

Block Library

R-60M 60" (1520mm) MIDDLE			R-60HM 60" (1520mm) HALF MIDDLE		
Face Texture:	Cobble / Limestone	Kingstone / Ledgestone	Face Texture:	Cobble / Limestone	Kingstone / Ledgestone
Block Weight:	3290 lb (1490 kg)	3220 lb (1460 kg)	Block Weight:	1340 lb (610 kg)	1300 lb (590 kg)
Block Volume:	23.00 ft³ (0.651 m³)	22.49 ft³ (0.637 m³)	Block Volume:	9.34 ft³ (0.264 m³)	9.09 ft³ (0.258 m³)
Center of Gravity:	31.0" (786 mm)	30.4" (772 mm)	Center of Gravity:	33.7" (856 mm)	33.1" (840 mm)

SHEAR KNOBS @ 23 (584) OC, TYP.

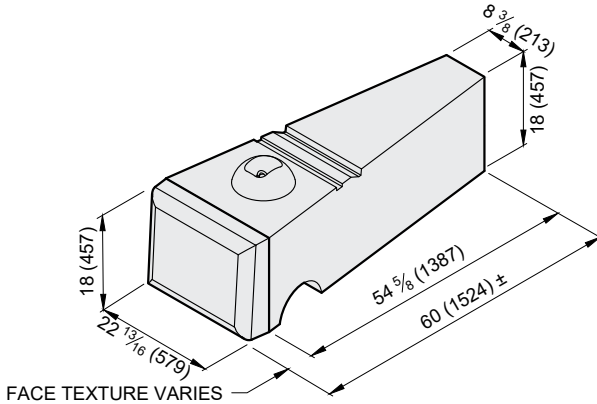
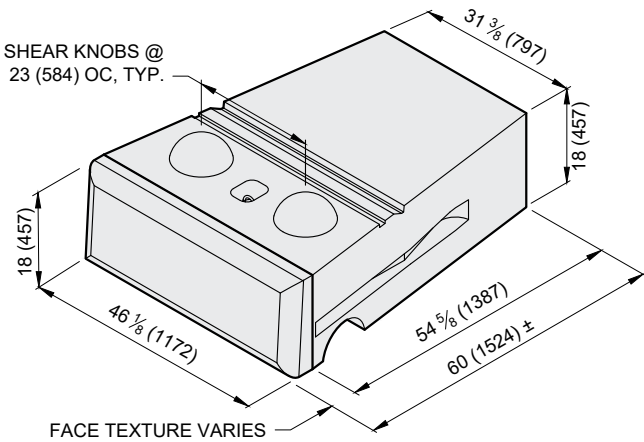

R-60B 60" (1520mm) BOTTOM			R-60HB 60" (1520mm) HALF BOTTOM		
Face Texture:	Cobble / Limestone	Kingstone / Ledgestone	Face Texture:	Cobble / Limestone	Kingstone / Ledgestone
Block Weight:	3420 lb (1550 kg)	3350 lb (1520 kg)	Block Weight:	1400 lb (630 kg)	1360 lb (620 kg)
Block Volume:	23.90 ft³ (0.677 m³)	23.40 ft³ (0.663 m³)	Block Volume:	9.77 ft³ (0.277 m³)	9.52 ft³ (0.270 m³)
Center of Gravity:	31.6" (802 mm)	31.0" (788 mm)	Center of Gravity:	34.3" (871 mm)	33.7" (856 mm)

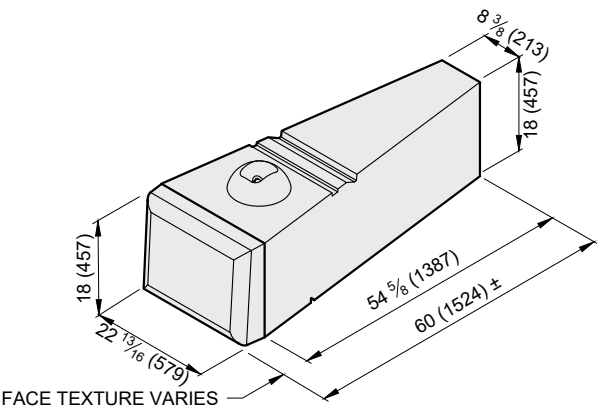
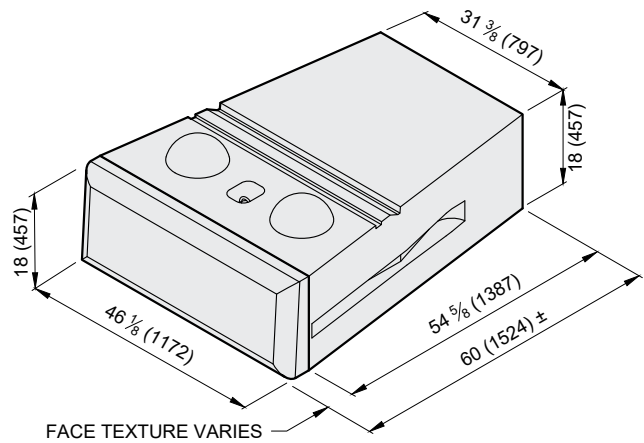

- Units for dimensions are inches (mm), typical unless noted otherwise.
- Block production varies with each licensed Redi-Rock manufacturer. Confirm availability before Specifying or Ordering.
- Center of Gravity is measured from the back of block.
- Actual block volumes and weights may vary.

- Weights are based upon a concrete density of 143 lb/ft³ (2291kg/m³).
- 60" (1520 mm) are typically used at the bottom of taller walls.
- Half blocks contain a fork slot on only one side of the block.
- Interface Shear knobs are typically 10" (254mm) diameter by 4" (102mm) tall. Smaller knob diameters are available.

RETAINING BLOCKS

Block Library

R-5236HC 52" (1320 mm) XL Hollow-Core

Face Texture:	Ledgestone
Block Weight:	3330 lb (1510 kg)
Block Volume:	23.29 ft³ (0.660 m³)
Infill Volume:	22.88 ft³ (0.648 m³)
Center of Gravity:	29.0" (737 mm)

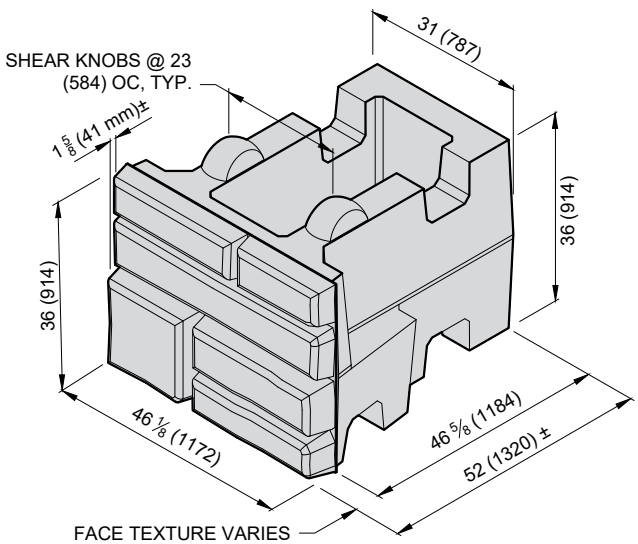

R-7236HC 72" (1830 mm) XL Hollow-Core

Face Texture:	Ledgestone
Block Weight:	4160 lb (1890 kg)
Block Volume:	29.10 ft³ (0.824 m³)
Infill Volume:	36.29 ft³ (1.028 m³)
Center of Gravity:	39.9" (1013 mm)

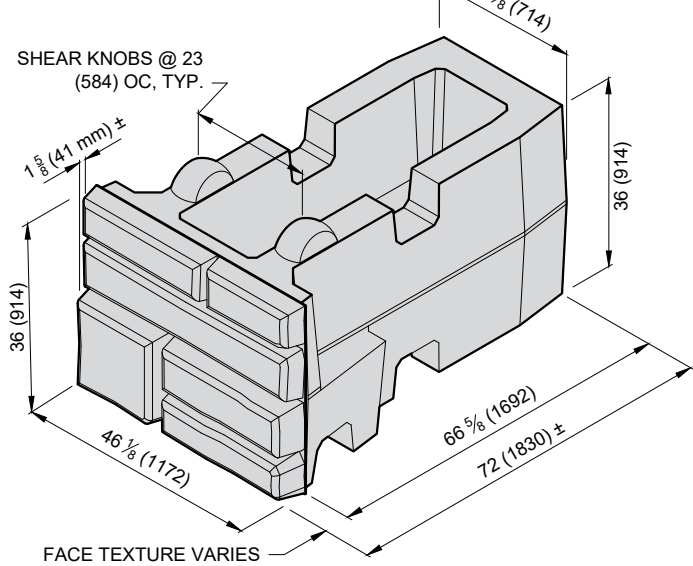

R-9636HC 96" (2440 mm) XL Hollow-Core

Face Texture:	Ledgestone
Block Weight:	4840 lb (2190 kg)
Block Volume:	33.83 ft³ (0.958 m³)
Infill Volume:	54.63 ft³ (1.547 m³)
Center of Gravity:	55.3" (1405 mm)

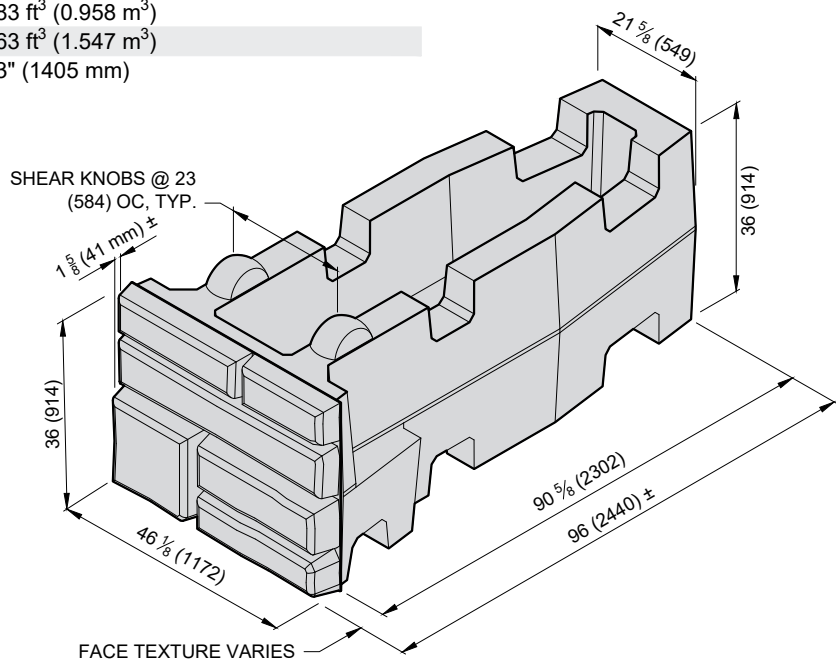

1. Units for dimensions are inches (mm), typical unless noted otherwise.
2. Block production varies with each licensed Redi-Rock manufacturer. Confirm availability before Specifying or Ordering.
3. Center of Gravity is measured from the back of block, excluding stone infill.

4. Actual block volumes and weights may vary.
5. Weights are based upon a concrete density of 143 lb/ft³ (2291kg/m³).
6. Interface Shear knobs are nominally 10" (254mm) diameter by 4" (102 mm) tall.

RETAINING BLOCKS

Block Library

R-419M

41" (1030mm) MIDDLE 9" (230mm) SETBACK

R-419HM

Face Texture:	Cobble / Limestone	Kingstone / Ledgestone	Face Texture:	Cobble / Limestone	Kingstone / Ledgestone
Block Weight:	2320 lb (1050 kg)	2250 lb (1020 kg)	Block Weight:	1030 lb (470 kg)	1000 lb (450 kg)
Block Volume:	16.21 ft³ (0.46 m³)	15.72 ft³ (0.44 m³)	Block Volume:	7.20 ft³ (0.20 m³)	6.96 ft³ (0.20 m³)
Center of Gravity:	20.2" (514 mm)	19.7" (500 mm)	Center of Gravity:	21.3" (540 mm)	20.7" (525 mm)

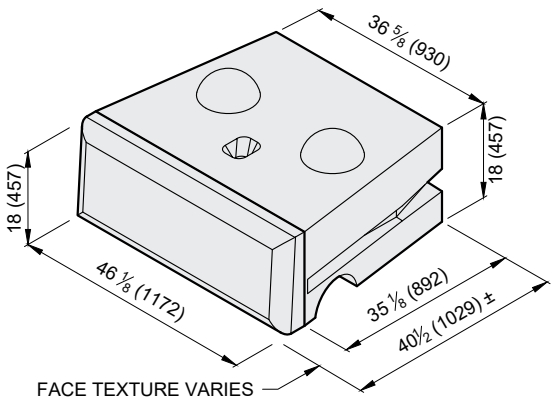

FULL MIDDLE

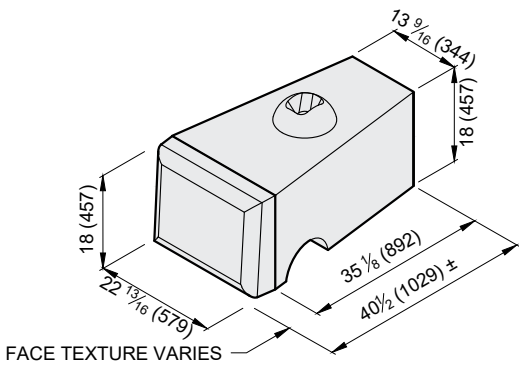

HALF MIDDLE

R-419B

41" (1030mm) BOTTOM 9" (230mm) SETBACK

R-419HB

Face Texture:	Cobble / Limestone	Kingstone / Ledgestone	Face Texture:	Cobble / Limestone	Kingstone / Ledgestone
Block Weight:	2450 lb (1110 kg)	2380 lb (1080 kg)	Block Weight:	1090 lb (500 kg)	1060 lb (480 kg)
Block Volume:	17.13 ft³ (0.48 m³)	16.63 ft³ (0.47 m³)	Block Volume:	7.63 ft³ (0.22 m³)	7.39 ft³ (0.21 m³)
Center of Gravity:	20.6" (523 mm)	20.1" (510 mm)	Center of Gravity:	21.6" (548 mm)	21.0" (534 mm)

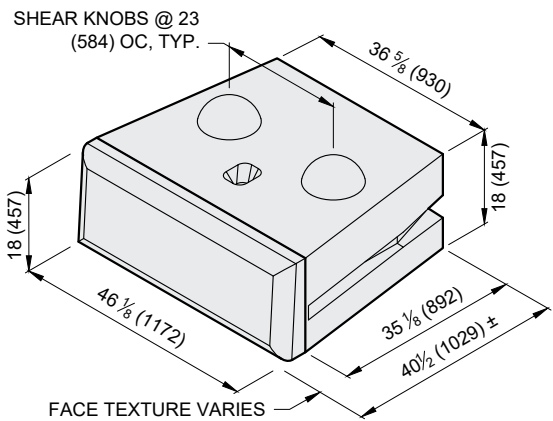

FULL BOTTOM

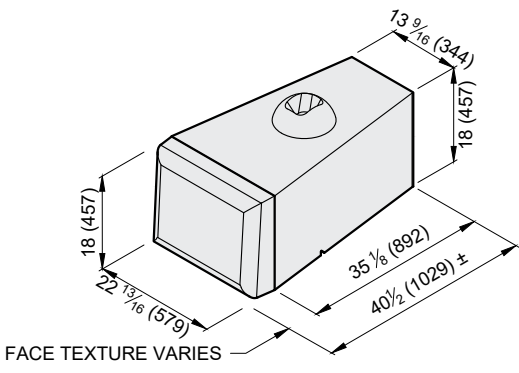

HALF BOTTOM

1. Units for dimensions are inches (mm), typical unless noted otherwise.
2. Block production varies with each licensed Redi-Rock manufacturer. Confirm availability before Specifying or Ordering.
3. Center of Gravity is measured from the back of block.
4. Actual block volumes and weights may vary.

5. Weights are based upon a concrete density of 143 lb/ft³ (2291kg/m³).
6. Half blocks contain a fork slot on only one side of the block.
7. Interface Shear knobs are typically 10" (254mm) diameter by 4" (102 mm) tall.

RETAINING BLOCKS

Block Library

R-609M 60" (1520mm) MIDDLE 9" (230mm) SETBACK			R-609HM		
Face Texture:	Cobble / Limestone	Kingstone / Ledgestone	Face Texture:	Cobble / Limestone	Kingstone / Ledgestone
Block Weight:	3300 lb (1500 kg)	3230 lb (1460 kg)	Block Weight:	1340 lb (610 kg)	1310 lb (590 kg)
Block Volume:	23.06 ft³ (0.65 m³)	22.56 ft³ (0.64 m³)	Block Volume:	9.37 ft³ (0.26 m³)	9.12 ft³ (0.26 m³)
Center of Gravity:	30.9" (785 mm)	30.3" (770 mm)	Center of Gravity:	33.6" (855 mm)	33.0" (839 mm)

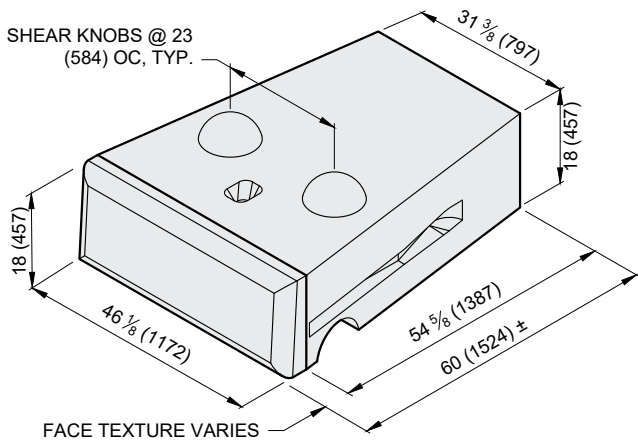

FULL MIDDLE

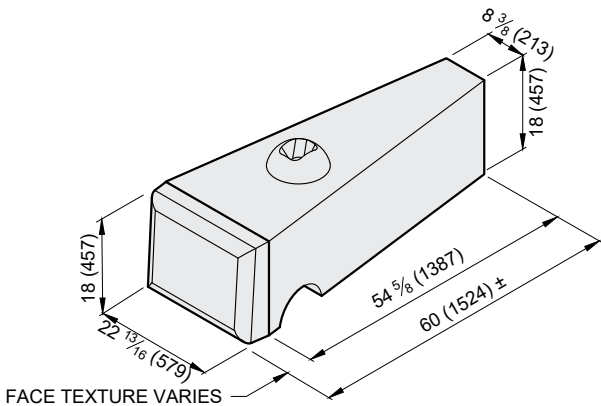

HALF MIDDLE

R-609B 60" (1520mm) BOTTOM 9" (230mm) SETBACK			R-609HB		
Face Texture:	Cobble / Limestone	Kingstone / Ledgestone	Face Texture:	Cobble / Limestone	Kingstone / Ledgestone
Block Weight:	3430 lb (1550 kg)	3360 lb (1520 kg)	Block Weight:	1400 lb (640 kg)	1370 lb (620 kg)
Block Volume:	23.97 ft³ (0.68 m³)	23.47 ft³ (0.66 m³)	Block Volume:	9.80 ft³ (0.28 m³)	9.55 ft³ (0.27 m³)
Center of Gravity:	31.5" (800 mm)	30.9" (786 mm)	Center of Gravity:	34.2" (869 mm)	33.6" (854 mm)

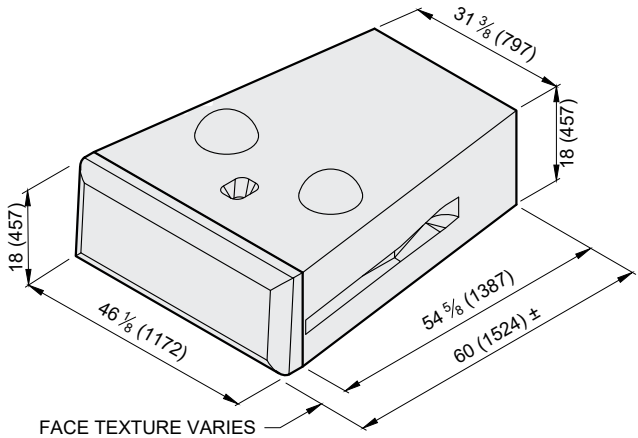

FULL BOTTOM

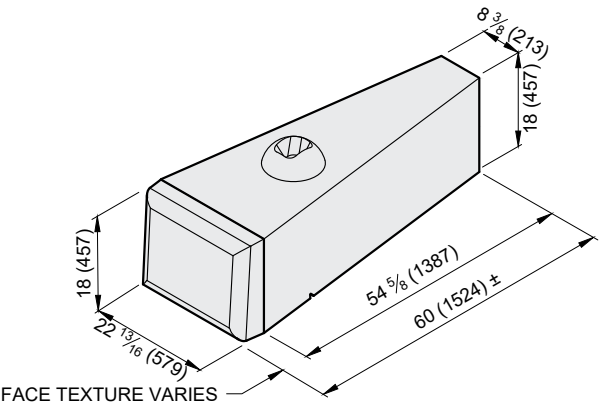

HALF BOTTOM

1. Units for dimensions are inches (mm), typical unless noted otherwise.

2. Block production varies with each licensed Redi-Rock manufacturer. Confirm availability before Specifying or Ordering.

3. Center of Gravity is measured from the back of block.

4. Actual block volumes and weights may vary.
5. Weights are based upon a concrete density of 143 lb/ft³ (2291kg/m³).

6. Half blocks contain a fork slot on only one side of the block.

7. Interface Shear knobs are typically 10" (254mm) diameter by 4" (102 mm) tall.

8. 60" (1520 mm) Blocks are typically used at the bottom of taller walls.

RETAINING BLOCKS

Block Library

R-28PCT 28" (710mm) PC TOP			R-41PCT 41" (1030mm) PC TOP		
Face Texture:	Cobble / Limestone	Kingstone / Ledgestone	Face Texture:	Cobble / Limestone	Kingstone / Ledgestone
Block Weight:	1170 lb (530 kg)	1100 lb (500 kg)	Block Weight:	1630 lb (740 kg)	1560 lb (710 kg)
Block Volume:	8.16 ft³ (0.231 m³)	7.66 ft³ (0.217 m³)	Block Volume:	11.38 ft³ (0.32 m³)	10.88 ft³ (0.31 m³)
Center of Gravity:	15.3" (388 mm)	14.6" (372 mm)	Center of Gravity:	21.8" (554 mm)	21.1" (536 mm)

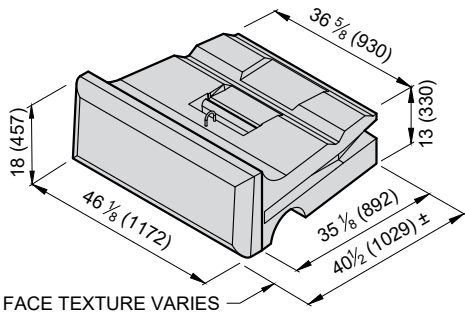
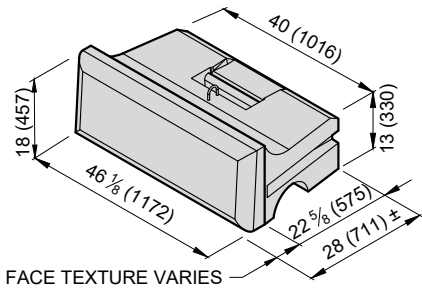

R-28PCM 28" (710mm) PC MIDDLE			R-41PCM 41" (1030mm) PC MIDDLE		
Face Texture:	Cobble / Limestone	Kingstone / Ledgestone	Face Texture:	Cobble / Limestone	Kingstone / Ledgestone
Block Weight:	1520 lb (690 kg)	1450 lb (660 kg)	Block Weight:	2170 lb (990 kg)	2100 lb (950 kg)
Block Volume:	10.62 ft³ (0.301 m³)	10.12 ft³ (0.287 m³)	Block Volume:	15.2 ft³ (0.43 m³)	14.69 ft³ (0.42 m³)
Center of Gravity:	14.2" (360 mm)	13.6" (346 mm)	Center of Gravity:	20.6" (522 mm)	20.0" (508 mm)

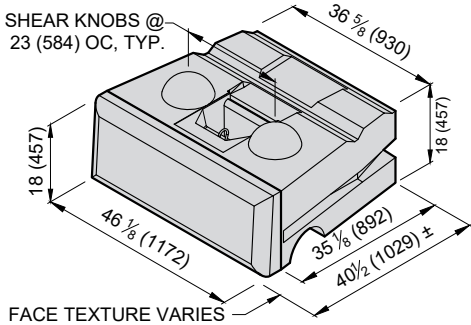
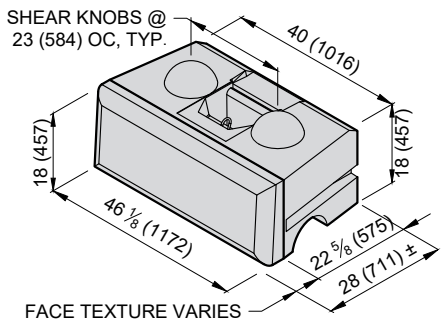

R-28PCB 28" (710mm) PC BOTTOM			R-41PCB 41" (1030mm) PC BOTTOM		
Face Texture:	Cobble / Limestone	Kingstone / Ledgestone	Face Texture:	Cobble / Limestone	Kingstone / Ledgestone
Block Weight:	1620 lb (740 kg)	1550 lb (700 kg)	Block Weight:	2280 lb (1030 kg)	2210 lb (1000 kg)
Block Volume:	11.34 ft³ (0.321 m³)	10.85 ft³ (0.307 m³)	Block Volume:	15.92 ft³ (0.45 m³)	15.42 ft³ (0.44 m³)
Center of Gravity:	14.2" (362 mm)	13.7" (349 mm)	Center of Gravity:	20.2" (514mm)	19.7" (501mm)

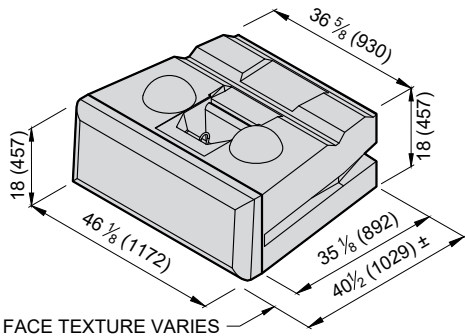
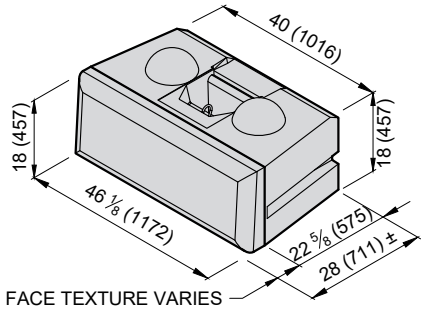

1. Units for dimensions are inches (mm), typical unless noted otherwise.

2. Block production varies with each licensed Redi-Rock manufacturer. Confirm availability before Specifying or Ordering.

3. Center of Gravity is measured from the back of block.

4. Actual block volumes and weights may vary.
5. Weights are based upon a concrete density of 143 lb/ft³ (2291kg/m³).

6. Blocks contain a vertical slot for a 12" (300 mm) strip of geogrid soil reinforcement.

7. Interface Shear knobs are typically 10" (254mm) diameter by 4" (102 mm) tall. Smaller knob diameters are available.

RETAINING BLOCKS

Block Library

R-41PL 41" (1030mm) PLANTER		
Face Texture:	Cobble / Limestone	Kingstone / Ledgestone
Block Weight:	2010 lb (910 kg)	1930 lb (880 kg)
Block Volume:	14.02 ft³ (0.40 m³)	13.53 ft³ (0.38 m³)
Center of Gravity:	19.1" (485 mm)	18.4" (468 mm)

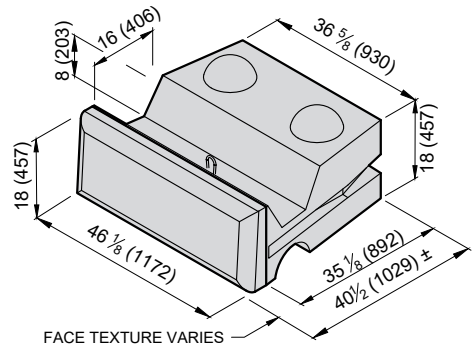

R-41HPL 41" (1030mm) HALF PLANTER		
Face Texture:	Cobble / Limestone	Kingstone / Ledgestone
Block Weight:	880 lb (400 kg)	840 lb (380 kg)
Block Volume:	6.14 ft³ (0.17 m³)	5.89 ft³ (0.17 m³)
Center of Gravity:	20.2" (513 mm)	19.5" (495 mm)

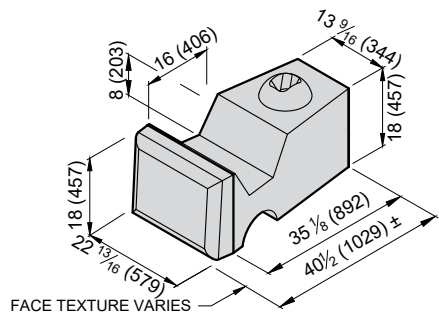

R-MT MODIFIED TOP		
Face Texture:	Cobble / Limestone	Kingstone / Ledgestone
Block Weight:	1200 lb (540 kg)	1130 lb (510 kg)
Block Volume:	8.38 ft³ (0.24 m³)	7.88 ft³ (0.22 m³)
Center of Gravity:	17.9" (455 mm)	17.2" (438 mm)

SPECIALITY BLOCK

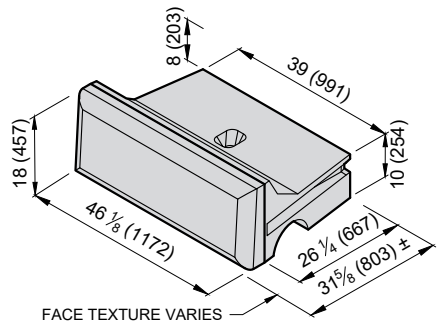

R-MHT MODIFIED HALF TOP		
Face Texture:	Cobble / Limestone	Kingstone / Ledgestone
Block Weight:	710 lb (320 kg)	640 lb (290 kg)
Block Volume:	4.95 ft³ (0.14 m³)	4.45 ft³ (0.13 m³)
Center of Gravity:	20.7" (527 mm)	19.8" (504 mm)

SPECIALITY BLOCK

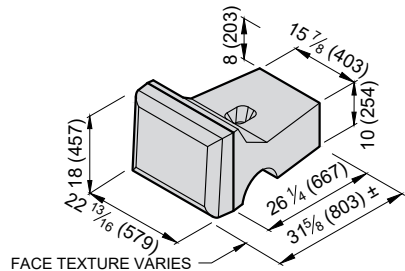

1. Units for dimensions are inches (mm), typical unless noted otherwise.

2. Block production varies with each licensed Redi-Rock manufacturer. Confirm availability before Specifying or Ordering.

3. Center of Gravity is measured from the back of block.

4. Actual block volumes and weights may vary.
5. Weights are based upon a concrete density of 143 lb/ft³ (2291kg/m³).

6. Half blocks contain a fork slot on only one side of the block.

7. Interface Shear knobs are typically 10" (254 mm) diameter by 4" (102 mm) tall.

RETAINING BLOCKS

Block Library

R-AB ANCHOR BOTTOM		
Face Texture:	Cobble / Limestone	Kingstone / Ledgestone
Block Weight:	2370 lb (1070 kg)	2290 lb (1040 kg)
Block Volume:	16.54 ft³ (0.47 m³)	16.04 ft³ (0.45 m³)
Center of Gravity:	21.0" (533 mm)	20.4" (519 mm)

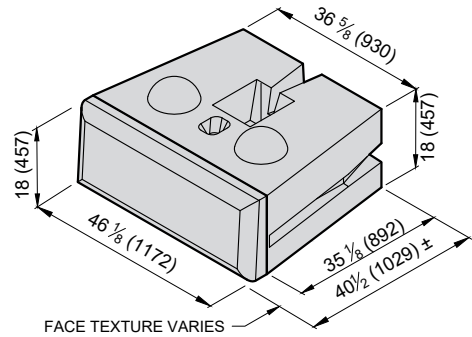

R-SM SHORT MIDDLE		
Face Texture:	Cobble / Limestone	Kingstone / Ledgestone
Block Weight:	2140 lb (970 kg)	2080 lb (940 kg)
Block Volume:	14.95 ft³ (0.42 m³)	14.51 ft³ (0.41 m³)
Center of Gravity:	19.7" (499mm)	19.2" (487mm)

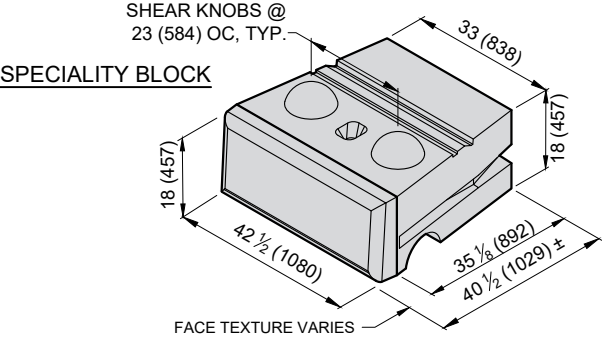

R-419SM 9" (230mm) SETBACK SHORT MID		
Face Texture:	Cobble / Limestone	Kingstone / Ledgestone
Block Weight:	1280 lb (580 kg)	1240 lb (560 kg)
Block Volume:	8.96 ft³ (0.25 m³)	8.66 ft³ (0.24 m³)
Center of Gravity:	20.0" (507mm)	19.5" (494mm)

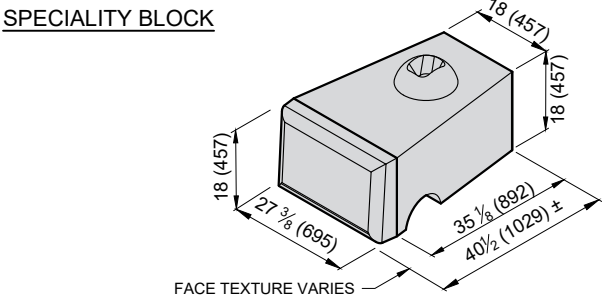

1. Units for dimensions are inches (mm), typical unless noted otherwise.

2. Block production varies with each licensed Redi-Rock manufacturer. Confirm availability before Specifying or Ordering.

3. Center of Gravity is measured from the back of block.

4. Actual block volumes and weights may vary.

R-AM ANCHOR MIDDLE		
Face Texture:	Cobble / Limestone	Kingstone / Ledgestone
Block Weight:	2240 lb (1010 kg)	2160 lb (980 kg)
Block Volume:	15.63 ft³ (0.44 m³)	15.13 ft³ (0.43 m³)
Center of Gravity:	20.6" (523 mm)	20.0" (509 mm)

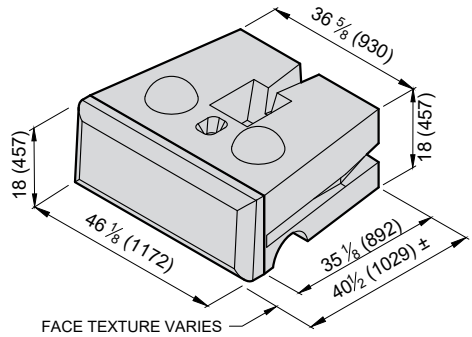

R-ST SHORT TOP		
Face Texture:	Cobble / Limestone	Kingstone / Ledgestone
Block Weight:	1110 lb (500 kg)	1050 lb (480 kg)
Block Volume:	7.77 ft³ (0.22 m³)	7.33 ft³ (0.21 m³)
Center of Gravity:	13.7" (349mm)	13.2" (336mm)

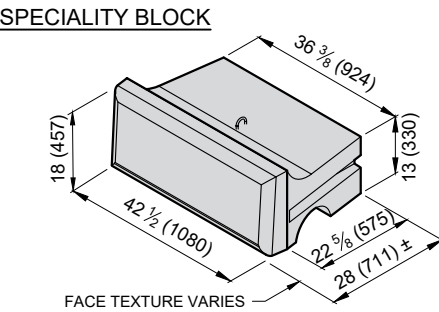

R-419ST 9" (230mm) SETBACK SHORT TOP		
Face Texture:	Cobble / Limestone	Kingstone / Ledgestone
Block Weight:	710 lb (320 kg)	660 lb (300 kg)
Block Volume:	4.94 ft³ (0.14 m³)	4.64 ft³ (0.13 m³)
Center of Gravity:	13.9" (352mm)	13.3" (339mm)

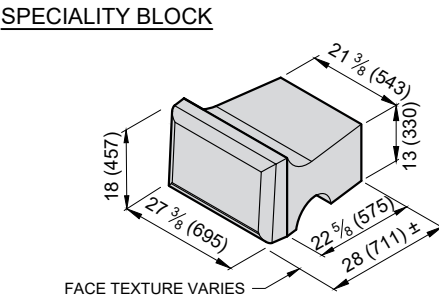

5. Weights are based upon a concrete density of 143 lb/ft³ (2291kg/m³).

6. 27" (695) wide blocks contain a fork slot on only one side of the block. These are speciality blocks and may have limited availability and is only used in double 90 degree corner applications.

7. Interface Shear knobs are typically 10" (254mm) diameter by 4" (102 mm) tall. Smaller knob diameters are available.

RETAINING BLOCKS

Block Library

R-28SDT			9" (230 mm) STEPDOWN TOP			R-41SDT		
Face Texture:	Cobble / Limestone	Kingstone / Ledgestone	Face Texture:	Cobble / Limestone	Kingstone / Ledgestone	Face Texture:	Cobble / Limestone	Kingstone / Ledgestone
Block Weight:	600 lb (270 kg)	500 lb (230 kg)	Block Weight:	840 lb (380 kg)	740 lb (340 kg)	Block Weight:	840 lb (380 kg)	740 lb (340 kg)
Block Volume:	4.2 ft³ (0.12 m³)	3.4 ft³ (0.10 m³)	Block Volume:	5.9 ft³ (0.17 m³)	5.1 ft³ (0.14 m³)	Block Volume:	5.9 ft³ (0.17 m³)	5.1 ft³ (0.14 m³)

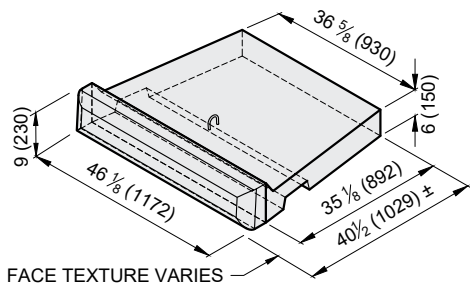
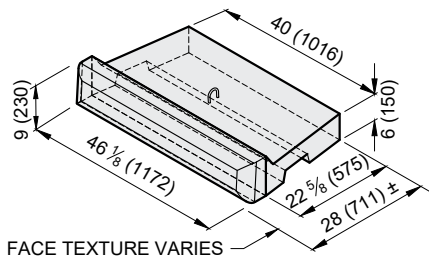

1. Units for dimensions are inches (mm), typical unless noted otherwise.

2. Block production varies with each licensed Redi-Rock manufacturer. Confirm availability before Specifying or Ordering.
3. Architectural faces on the blocks have varying texture.

4. Actual block volumes and weights may vary.

5. Weights are based upon a concrete density of 143 lb/ft³ (2291 kg/m³).



FREESTANDING BLOCKS
(FINISHED TEXTURE ON MORE THAN ONE FACE)

The Redi-Rock Freestanding blocks come in one width and stack in a vertical manner. The defining characteristic is that freestanding blocks have an aesthetic texture cast into multiple faces; the textured face is on at least the two longitudinal vertical faces, and also as required on one end or the top of the blocks. These blocks are machine-placed, wet-cast, precast modular block units manufactured from first purpose, non-reconstituted concrete and intended for constructing dry-stacked modular retaining wall systems. The block units are manufactured from structural-grade concrete mixes in accordance with ASTM C94 or ASTM C685 that produce a finished unit with excellent resistance to freeze-thaw, deicing chemical exposure, and submerged conditions in both fresh water and salt water applications. All Redi-Rock blocks are manufactured and distributed through an international network of individually-owned, licensed precast concrete manufacturers.

CONCRETE MIX PROPERTIES ⁽¹⁾

FREEZE THAW EXPOSURE CLASS ⁽²⁾	MINIMUM 28 DAY COMPRESSIVE STRENGTH ⁽³⁾	MAXIMUM WATER CEMENT RATIO	NOMINAL MAXIMUM AGGREGATE SIZE ⁽¹⁰⁾	AGGREGATE CLASS DESIGNATION ⁽⁴⁾	AIR CONTENT ⁽⁵⁾
MODERATE	4,000 psi (27.6 MPa)	0.45	1.0 (25)	3M	4.5% ± 1.5%
SEVERE	4,000 psi (27.6 MPa)	0.45	1.0 (25)	3S	6.0% ± 1.5%
VERY SEVERE	4,500 psi (30.0 MPa)	0.40	1.0 (25)	4S	6.0% ± 1.5%
MAXIMUM WATER-SOLUBLE CHLORIDE ION (Cl ⁻) CONTENT IN CONCRETE, PERCENT BY WEIGHT OF CEMENT ^(6,7)					0.15
MAXIMUM CHLORIDE AS Cl ⁻ CONCENTRATION IN MIXING WATER, PARTS PER MILLION					1000
MAXIMUM PERCENTAGE OF TOTAL CEMENTITIOUS MATERIALS BY WEIGHT ^(8,10) (VERY SEVERE EXPOSURE CLASS ONLY)					
FLY ASH OR OTHER POZZOLANS PER ASTM C618		25	TOTAL ASH, POZZOLANS, SLAG, AND SILICA FUME ⁽⁹⁾		50
SLAG CONFORMING TO ASTM C989		50	TOTAL ASH, POZZOLANS, AND SILICA FUME ⁽⁹⁾		35
SILICA FUME CONFORMING TO ASTM C1240		10	ALKALI-AGGREGATE REACTIVITY MITIGATION PER ACI 201		

REFERENCE DIMENSIONS:

HEIGHT = VERTICAL DIMENSION OF TEXTURED FACE
LENGTH = LONGER HORIZONTAL DIMENSION PARALLEL TO TEXTURED FACES
WIDTH = HORIZONTAL DIMENSION PERPENDICULAR TO LONGER TEXTURED FACES

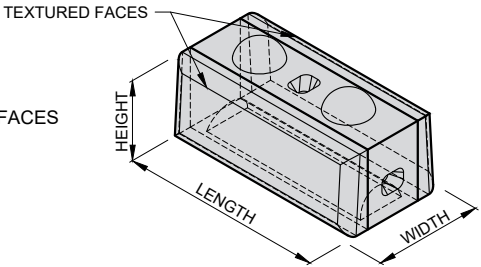

DIMENSIONAL TOLERANCES ⁽¹¹⁾ ⁽¹²⁾

HEIGHT	ALL BLOCKS	18 ± 3⁄16 (457 ± 5)
LENGTH	FULL BLOCKS	46⅞ ± ½ (1172 ± 13)
	HALF BLOCKS	22⅜ ± ½ (579 ± 13)
WIDTH	23 -24 (584-610)	13 ± ½ (330 ± 13) FORM LINE TO FORM LINE, PLUS APPROX. 5⁄8 (136) FACE TEXTURE ON LONG SIDES

⁽¹⁾ Concrete mix properties are in general accordance with ACI 318 durability requirements. Research has shown that concrete manufactured to these standards demonstrates good durability and performance. When these requirements are followed, specific freeze-thaw testing of the concrete is typically NOT required.

⁽²⁾ Exposure class is as described in ACI 318.

⁽³⁾ Test method ASTM C39.

⁽⁴⁾ Defined in ASTM C33 Table 3 *Limits for Deleterious Substances and Physical Property Requirements of Coarse Aggregate for Concrete*.

⁽⁵⁾ Test method ASTM C231.

⁽⁶⁾ Test method ASTM C1218 at age between 28 and 42 days.

⁽⁷⁾ Where used in high sulfate environments or where alkali-silica reactivity is and issue, watesoluble chloride shall be limited to no more than trace amounts (from impurities in concrete-making components, not intended constituents.)

⁽⁸⁾ The total cementitious material also includes ASTM C150, C595, C845, and C1157 cement. The maximum percentages shall include:

(a) Fly ash or other pozzolans in type IP, blended cement, ASTM C595, or ASTM C1157.

(b) Slag used in the manufacture of an IS blended cement, ASTM C595, or ASTM C1157.

(c) Silica fume, ASTM C1240, present in a blended cement.

⁽⁹⁾ Fly ash or other pozzolans and silica fume shall constitute no more than 25 and 10 percent, respectively, of the total weight of the cementitious materials.

⁽¹⁰⁾ Prescriptive limits shown may be waived for concrete mixes that demonstrate excellent freeze-thaw durability in a detailed and current testing program.

⁽¹¹⁾ All dimensions are shown in units of *inches (mm)*.

⁽¹²⁾ Permissible defects: Chips smaller than 1.5 (38) in its largest dimension and cracks not wider than 0.012 (0.305) and not longer than 25% of the nominal height of the block; bug holes in the architectural face smaller than 0.75 (19); and bug holes, water marks, and color variation on non-architectural faces.

FREESTANDING BLOCKS

Block Library

F-SM	STRAIGHT MIDDLE		F-SG	STRAIGHT GARDEN TOP	
Face Texture:	Cobble / Limestone	Kingstone / Ledgestone	Face Texture:	Cobble / Limestone	Kingstone / Ledgestone
Block Weight:	1410 lb (640 kg)	1260 lb (570 kg)	Block Weight:	1050 lb (480 kg)	910 lb (410 kg)
Block Volume:	9.84 ft³ (0.279 m³)	8.84 ft³ (0.250 m³)	Block Volume:	7.35 ft³ (0.208 m³)	6.35 ft³ (0.180 m³)

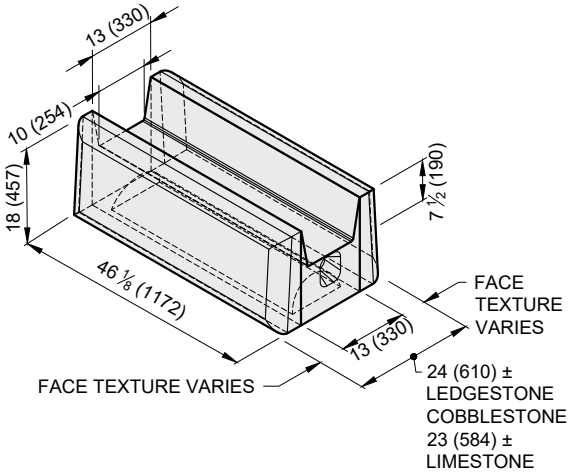
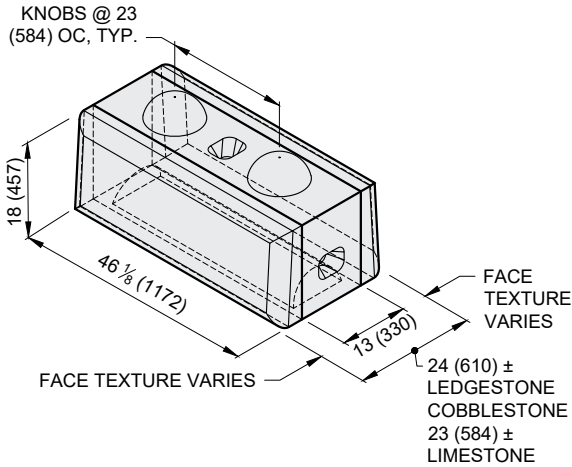

F-SB	STRAIGHT BOTTOM		F-ST	STRAIGHT TOP	
Face Texture:	Cobble / Limestone	Kingstone / Ledgestone	Face Texture:	Cobble / Limestone	Kingstone / Ledgestone
Block Weight:	1520 lb (690 kg)	1380 lb (630 kg)	Block Weight:	1380 lb (620 kg)	1230 lb (560 kg)
Block Volume:	10.65 ft³ (0.302 m³)	9.66 ft³ (0.273 m³)	Block Volume:	9.61 ft³ (0.272 m³)	8.62 ft³ (0.244 m³)

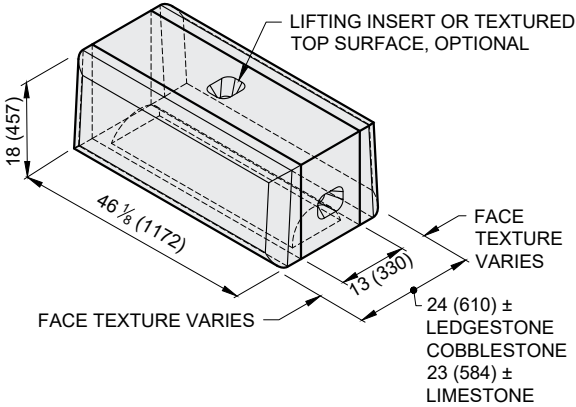
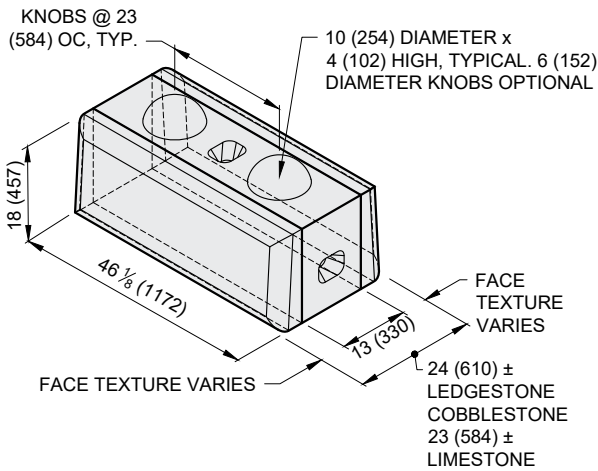

1. Units for dimensions are inches (mm), typical unless noted otherwise.

2. Block production varies with each licensed Redi-Rock manufacturer. Confirm availability before Specifying or Ordering.

3. Architectural faces on the blocks have varying texture.

4. Actual block volumes and weights may vary.
5. Weights are based upon a concrete density of 143 lb/ft³ (2291 kg/m³).

6. 6" (152 mm) diameter vertical semi-cylindrical voids at the ends of the block for mechanical tie-down are available, refer to Force Protection blocks for additional information.

7. Knobs are typically 10" (254mm) diameter by 4" (102 mm) tall. Smaller knobs are available.

FREESTANDING BLOCKS

Block Library

F-VM VARIABLE RADIUS MIDDLE		
Face Texture:	Cobble / Limestone	Kingstone / Ledgestone
Block Weight:	1270 lb (570 kg)	1120 lb (510 kg)
Block Volume:	8.86 ft³ (0.251 m³)	7.86 ft³ (0.223 m³)

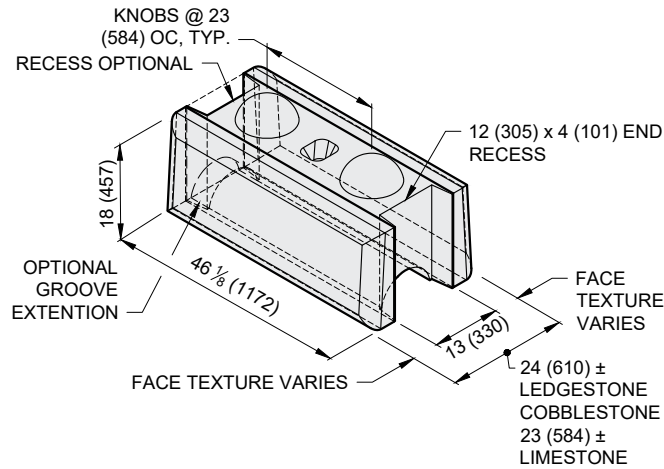

F-VG VARIABLE RADIUS GARDEN TOP		
Face Texture:	Cobble / Limestone	Kingstone / Ledgestone
Block Weight:	970 lb (440 kg)	820 lb (370 kg)
Block Volume:	6.76 ft³ (0.191 m³)	5.76 ft³ (0.163 m³)

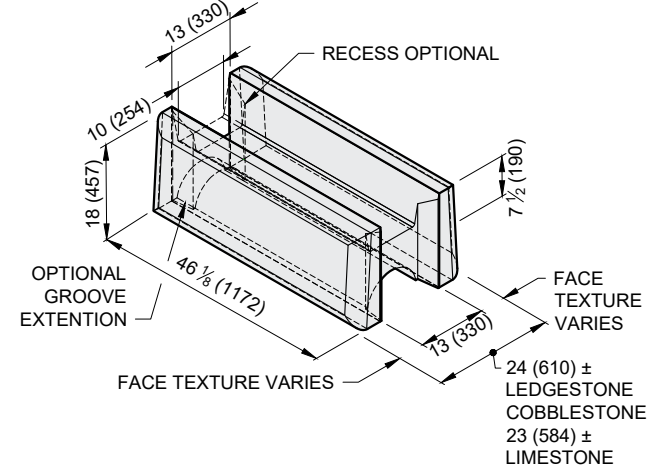

F-VB VARIABLE RADIUS BOTTOM		
Face Texture:	Cobble / Limestone	Kingstone / Ledgestone
Block Weight:	1380 lb (630 kg)	1240 lb (560 kg)
Block Volume:	9.65 ft³ (0.273 m³)	8.66 ft³ (0.245 m³)

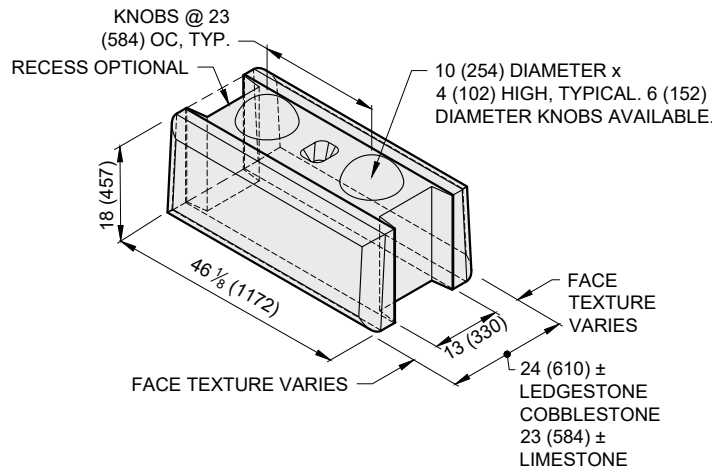

F-VT VARIABLE RADIUS TOP		
Face Texture:	Cobble / Limestone	Kingstone / Ledgestone
Block Weight:	1240 lb (560 kg)	1090 lb (500 kg)
Block Volume:	8.63 ft³ (0.244 m³)	7.64 ft³ (0.216 m³)

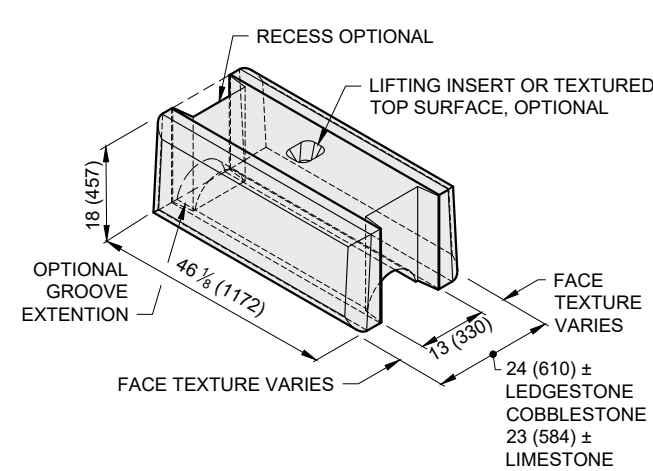

1. Units for dimensions are inches (mm), typical unless noted otherwise.
2. Block production varies with each licensed Redi-Rock manufacturer. Confirm availability before Specifying or Ordering.
3. Variable radius feature can be cast on only one end, coordinate.

4. Architectural faces on the blocks have varying texture.
5. Actual block volumes and weights may vary.
6. Weights are based upon a concrete density of 143 lb/ft³ (2291 kg/m³).
7. Knobs are typically 10" (254 mm) diameter by 4" (102 mm) tall. Smaller knobs are available.

FREESTANDING BLOCKS

Block Library

F-FM FORCE PROTECTION MIDDLE		
Face Texture:	Cobble / Limestone	Kingstone / Ledgestone
Block Weight:	1350 lb (610 kg)	1200 lb (550 kg)
Block Volume:	9.41 ft³ (0.267 m³)	8.42 ft³ (0.238 m³)

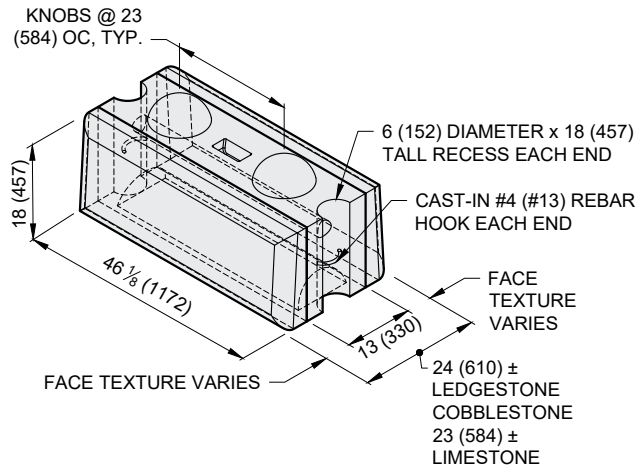

F-FT FORCE PROTECTION TOP		
Face Texture:	Cobble / Limestone	Kingstone / Ledgestone
Block Weight:	1310 lb (600 kg)	1170 lb (530 kg)
Block Volume:	9.19 ft³ (0.260 m³)	8.19 ft³ (0.232 m³)

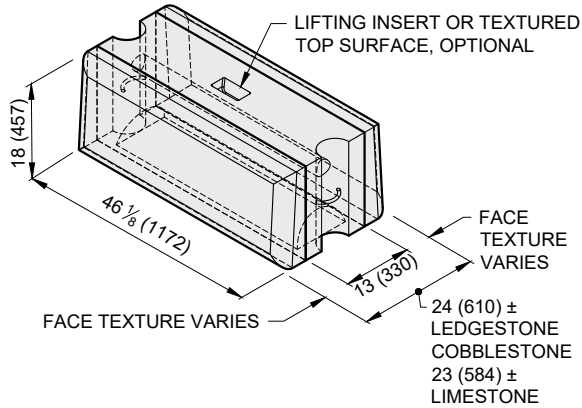

F-FB FORCE PROTECTION BOTTOM		
Face Texture:	Cobble / Limestone	Kingstone / Ledgestone
Block Weight:	1460 lb (660 kg)	1320 lb (600 kg)
Block Volume:	10.23 ft³ (0.290 m³)	9.23 ft³ (0.261 m³)

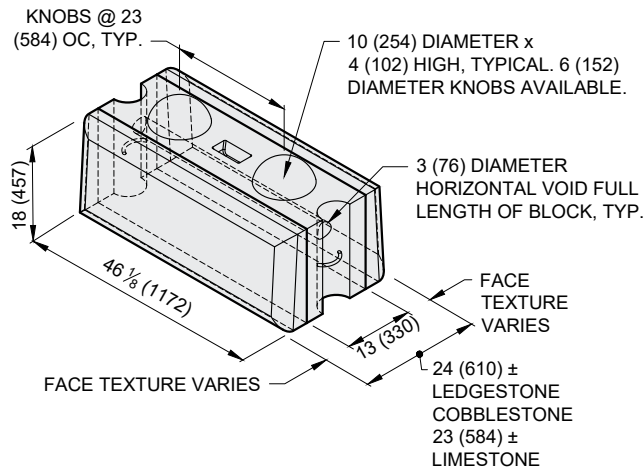

1. Units for dimensions are inches (mm), typical unless noted otherwise.
2. Block production varies with each licensed Redi-Rock manufacturer. Confirm availability before Specifying or Ordering.
3. Architectural faces on the blocks have varying texture.

F-BB BARRIER BLOCK	
Block Weight:	9,350 lb (4,240 kg)
Block Volume:	65.4 ft³ (1.85 m³)

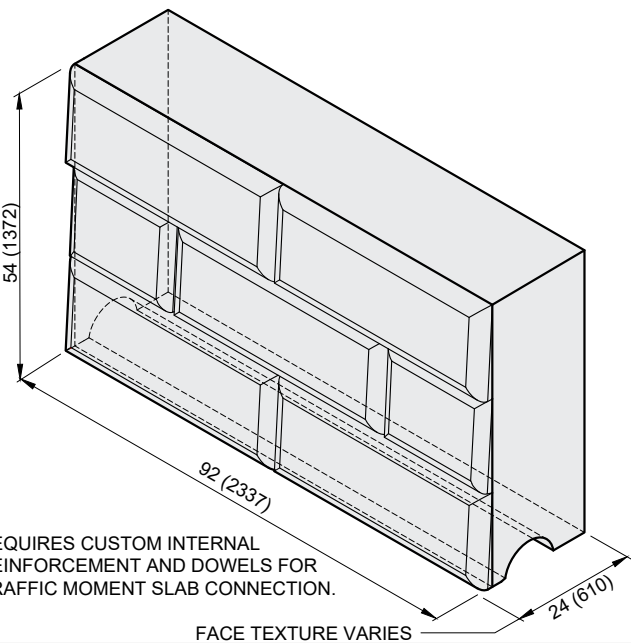

4. Actual block volumes and weights may vary.
5. Weights are based upon a concrete density of 143 lb/ft³ (2291 kg/m³).
6. Knobs are typically 10" (254mm) diameter by 4" (102 mm) tall. Smaller knobs are available.

FREESTANDING BLOCKS

Block Library

F-CM CORNER MIDDLE			F-CG CORNER GARDEN TOP		
Face Texture:	Cobble / Limestone	Kingstone / Ledgestone	Face Texture:	Cobble / Limestone	Kingstone / Ledgestone
Block Weight:	1370 lb (620 kg)	1360 lb (620 kg)	Block Weight:	1070 lb (480 kg)	1060 lb (480 kg)
Block Volume:	9.6 ft ³ (0.27m ³)	9.5 ft ³ (0.27m ³)	Block Volume:	7.5 ft ³ (0.21m ³)	7.4 ft ³ (0.21m ³)

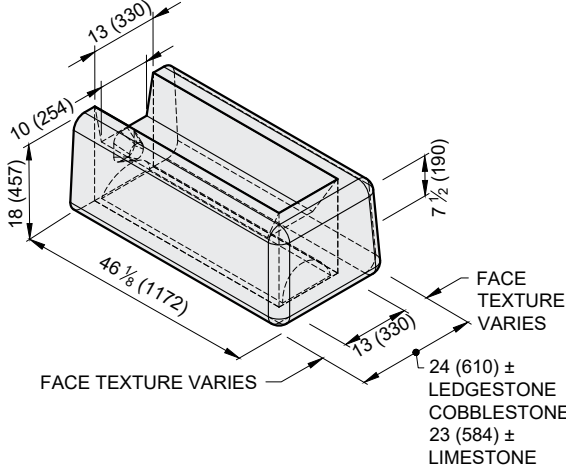
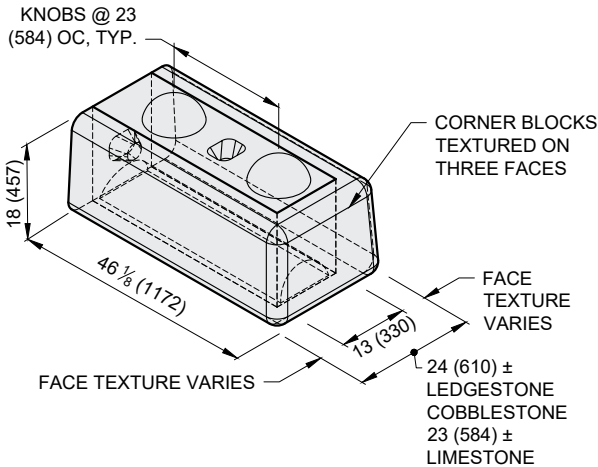

F-CB CORNER BOTTOM			F-CT CORNER TOP		
Face Texture:	Cobble / Limestone	Kingstone / Ledgestone	Face Texture:	Cobble / Limestone	Kingstone / Ledgestone
Block Weight:	1490 lb (680 kg)	1480 lb (670 kg)	Block Weight:	1340 lb (610 kg)	1330 lb (600 kg)
Block Volume:	10.4 ft ³ (0.30m ³)	10.3 ft ³ (0.29m ³)	Block Volume:	9.4 ft ³ (0.26m ³)	9.3 ft ³ (0.26m ³)

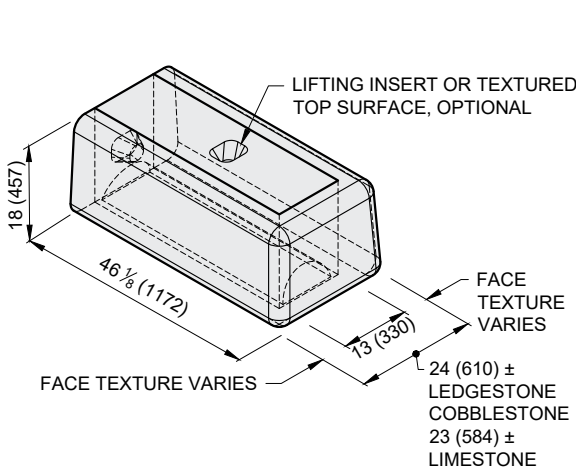
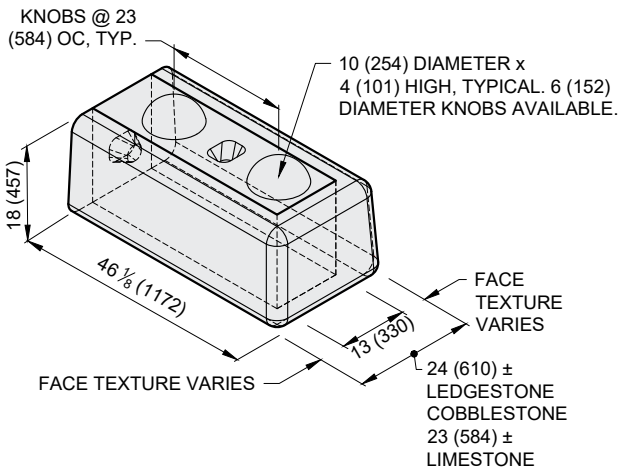

1. Units for dimensions are inches (mm), typical unless noted otherwise.
2. Block production varies with each licensed Redi-Rock manufacturer. Confirm availability before Specifying or Ordering.
3. Architectural faces on the blocks have varying texture.
4. Actual block volumes and weights may vary.
5. Weights are based upon a concrete density of 143 lb/ft³ (2291 kg/m³).
6. Knobs are typically 10" (254mm) diameter by 4" (102 mm) tall. Smaller knobs are available.

FREESTANDING BLOCKS

Block Library

F-HCM HALF CORNER MIDDLE			F-HCG HALF CORNER GARDEN TOP		
Face Texture:	Cobble / Limestone	Kingstone / Ledgestone	Face Texture:	Cobble / Limestone	Kingstone / Ledgestone
Block Weight:	660 lb (300 kg)	650 lb (300 kg)	Block Weight:	530 lb (240 kg)	530 lb (240 kg)
Block Volume:	4.6 ft ³ (0.13m ³)	4.6 ft ³ (0.13m ³)	Block Volume:	3.7 ft ³ (0.11m ³)	3.7 ft ³ (0.10m ³)

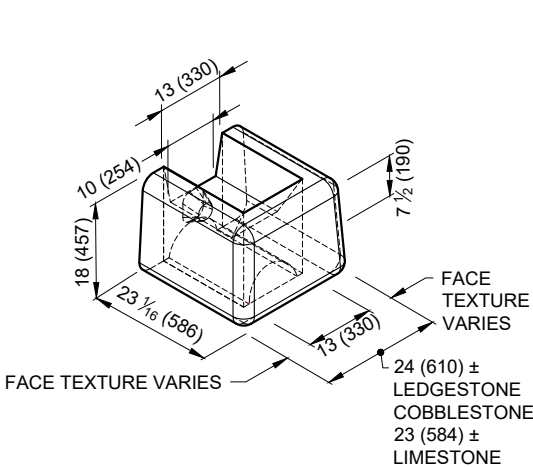
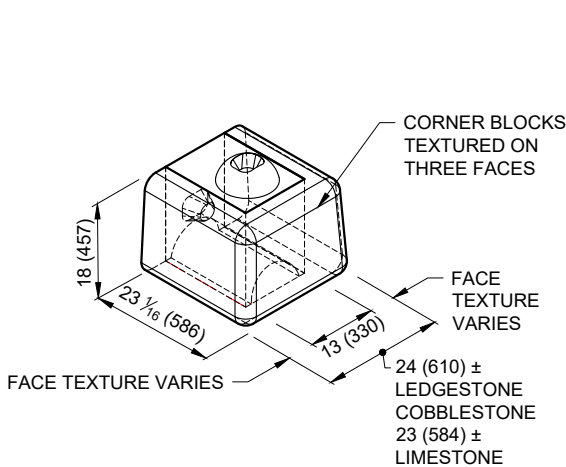

F-HCB HALF CORNER BOTTOM			F-HCT HALF CORNER TOP		
Face Texture:	Cobble / Limestone	Kingstone / Ledgestone	Face Texture:	Cobble / Limestone	Kingstone / Ledgestone
Block Weight:	710 lb (320 kg)	700 lb (320 kg)	Block Weight:	640 lb (290 kg)	630 lb (290 kg)
Block Volume:	5.0 ft ³ (0.14m ³)	4.9 ft ³ (0.14m ³)	Block Volume:	4.5 ft ³ (0.13m ³)	4.4 ft ³ (0.13m ³)

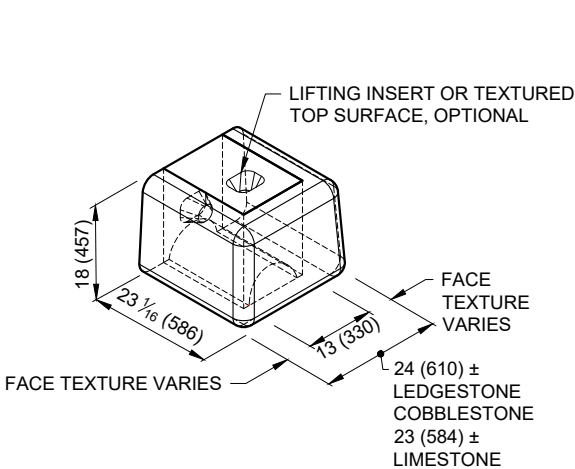
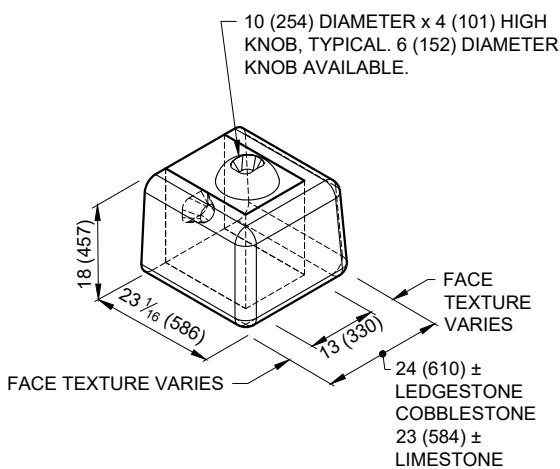

1. Units for dimensions are inches (mm), typical unless noted otherwise.
2. Block production varies with each licensed Redi-Rock manufacturer. Confirm availability before Specifying or Ordering.
3. Architectural faces on the blocks have varying texture.
4. Actual block volumes and weights may vary.
5. Weights are based upon a concrete density of 143 lb/ft³ (2291 kg/m³).
6. Knobs are typically 10" (254mm) diameter by 4" (102 mm) tall. Smaller knobs are available.

FREESTANDING BLOCKS

Block Library

F-HC HOLLOW-CORE			F-CHC CORNER HOLLOW-CORE		
Face Texture:	Cobble / Limestone	Kingstone / Ledgestone	Face Texture:	Cobble / Limestone	Kingstone / Ledgestone
Block Weight:	910 lb (410 kg)	770 lb (350 kg)	Block Weight:	1000 lb (460 kg)	970 lb (440 kg)
Block Volume:	6.38 ft³ (0.181 m³)	5.38 ft³ (0.152 m³)	Block Volume:	7.01 ft³ (0.198 m³)	6.80 ft³ (0.192 m³)
Infill Volume:	4.09 ft³ (0.116 m³)		Infill Volume:	3.37 ft³ (0.095 m³)	

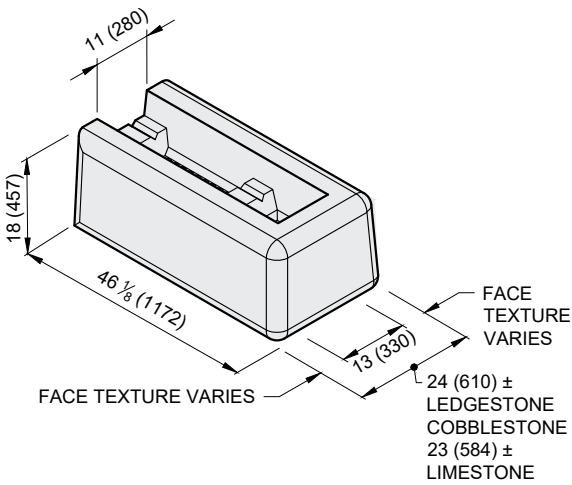
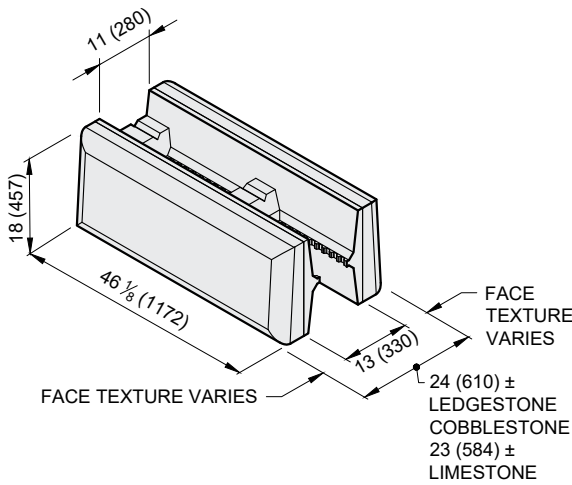

F-HHC HALF HOLLOW-CORE			F-HCHC HALF CORNER HOLLOW-CORE		
Face Texture:	Cobble / Limestone	Kingstone / Ledgestone	Face Texture:	Cobble / Limestone	Kingstone / Ledgestone
Block Weight:	460 lb (210 kg)	390 lb (180 kg)	Block Weight:	550 lb (250 kg)	510 lb (230 kg)
Block Volume:	3.19 ft³ (0.090 m³)	2.69 ft³ (0.076 m³)	Block Volume:	3.81 ft³ (0.108 m³)	3.53 ft³ (0.100 m³)
Infill Volume:	2.04 ft³ (0.058 m³)		Infill Volume:	1.31 ft³ (0.037 m³)	

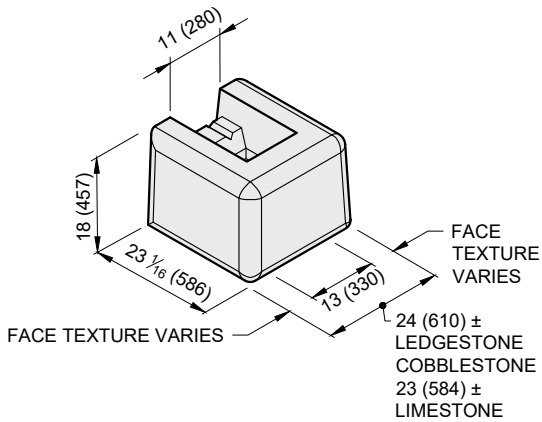
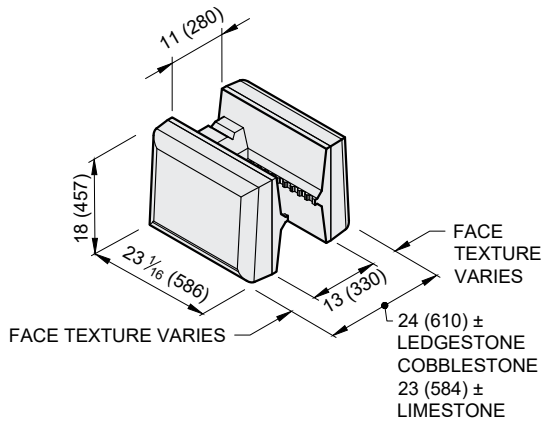

1. Units for dimensions are inches (mm), typical unless noted otherwise.
2. Confirm block production with licensed Redi-Rock manufacturer.
3. Architectural faces on the blocks have varying texture.
4. Average block weights shown. Actual block volumes and weights may vary.
5. Weights are based upon a concrete density of 143 lb/ft³ (2291 kg/m³).

FREESTANDING BLOCKS

Block Library

F-9SC 9" (230) STEPDOWN CORNER			F-9SG 9" (230) STEPDOWN GARDEN		
Face Texture:	Cobble / Limestone	Kingstone / Ledgestone	Face Texture:	Cobble / Limestone	Kingstone / Ledgestone
Block Weight:	740 lb (340 kg)	660 lb (300 kg)	Block Weight:	550 lb (250 kg)	470 lb (210 kg)
Block Volume:	5.17 ft³ (0.146 m³)	4.60 ft³ (0.130 m³)	Block Volume:	3.86 ft³ (0.109 m³)	3.30 ft³ (0.093 m³)

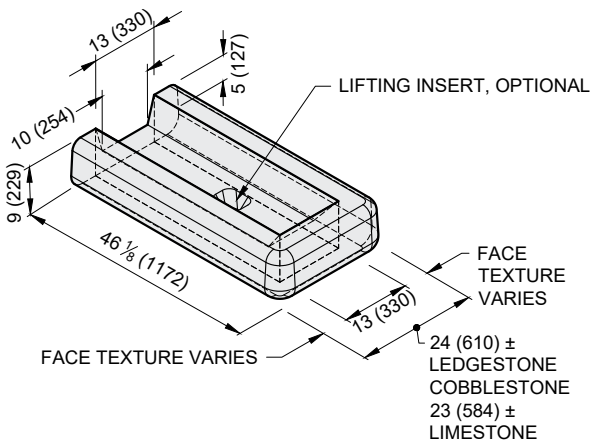
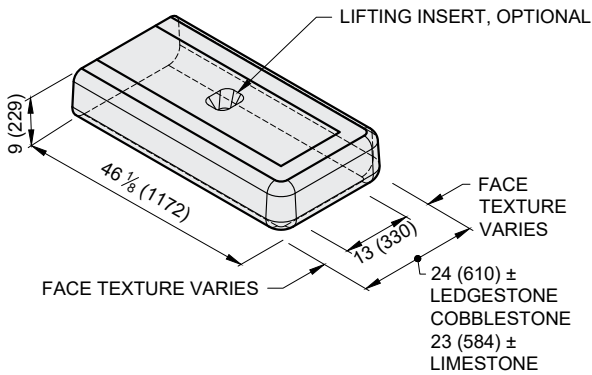

F-90C 90 DEGREE CORNER		
Face Texture:	Cobble / Limestone	Kingstone / Ledgestone
Block Weight:	1330 lb (600 kg)	1320 lb (600 kg)
Block Volume:	9.3 ft³ (0.26m³)	9.2 ft³ (0.26m³)

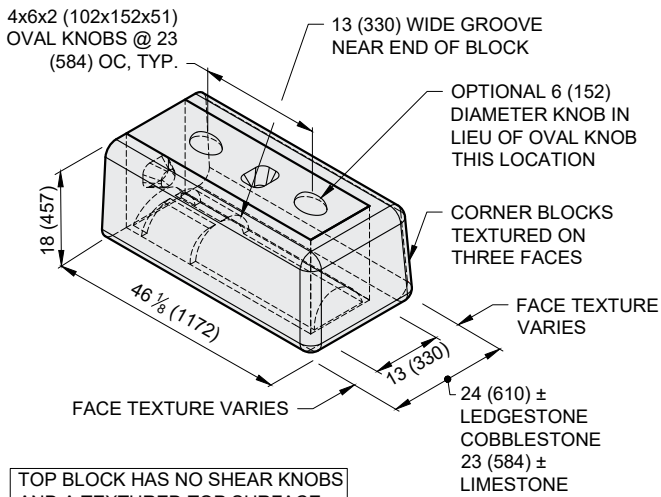

1. Units for dimensions are inches (mm), typical unless noted otherwise.
2. Block production varies with each licensed Redi-Rock manufacturer. Confirm availability before Specifying or Ordering.
3. Architectural faces on the blocks have varying texture.
4. Actual block volumes and weights may vary.
5. Weights are based upon a concrete density of 143 lb/ft³ (2291 kg/m³).



ACCESSORY BLOCKS
(COLUMNS, STEPS, AND CAPS)

The Redi-Rock Column and Accessory blocks come in multiple widths and configurations. The defining characteristic is that these blocks have an aesthetic texture cast into two or more faces, and create columns, caps, and steps that complement both Retaining and Freestanding blocks. These blocks are machine-placed, wet-cast, precast modular block units manufactured from first purpose, non-reconstituted concrete and intended for constructing dry-stacked modular features that coordinate with retaining walls. The block units are manufactured from structural-grade concrete mixes in accordance with ASTM C94 or ASTM C685 that produce a finished unit with excellent resistance to freeze-thaw, deicing chemical exposure, and submerged conditions in both fresh water and salt water applications. All Redi-Rock blocks are manufactured and distributed through an international network of individually-owned, licensed precast concrete manufacturers.

CONCRETE MIX PROPERTIES ⁽¹⁾

FREEZE THAW EXPOSURE CLASS ⁽²⁾	MINIMUM 28 DAY COMPRESSIVE STRENGTH ⁽³⁾	MAXIMUM WATER CEMENT RATIO	NOMINAL MAXIMUM AGGREGATE SIZE ⁽¹⁰⁾	AGGREGATE CLASS DESIGNATION ⁽⁴⁾	AIR CONTENT ⁽⁵⁾
MODERATE	4,000 psi (27.6 MPa)	0.45	1.0 (25)	3M	4.5% ± 1.5%
SEVERE	4,000 psi (27.6 MPa)	0.45	1.0 (25)	3S	6.0% ± 1.5%
VERY SEVERE	4,500 psi (30.0 MPa)	0.40	1.0 (25)	4S	6.0% ± 1.5%
MAXIMUM WATER-SOLUBLE CHLORIDE ION (Cl ⁻) CONTENT IN CONCRETE, PERCENT BY WEIGHT OF CEMENT ^(6,7)					0.15
MAXIMUM CHLORIDE AS Cl ⁻ CONCENTRATION IN MIXING WATER, PARTS PER MILLION					1000
MAXIMUM PERCENTAGE OF TOTAL CEMENTITIOUS MATERIALS BY WEIGHT ^(8,10) (VERY SEVERE EXPOSURE CLASS ONLY)					
FLY ASH OR OTHER POZZOLANS PER ASTM C618		25	TOTAL ASH, POZZOLANS, SLAG, AND SILICA FUME ⁽⁹⁾		50
SLAG CONFORMING TO ASTM C989		50	TOTAL ASH, POZZOLANS, AND SILICA FUME ⁽⁹⁾		35
SILICA FUME CONFORMING TO ASTM C1240		10	ALKALI-AGGREGATE REACTIVITY MITIGATION PER ACI 201		

REFERENCE DIMENSIONS:

HEIGHT = VERTICAL DIMENSION OF TEXTURED FACE
LENGTH = LONGER HORIZONTAL DIMENSION OF TEXTURED FACE
WIDTH = SHORTER HORIZONTAL DIMENSION

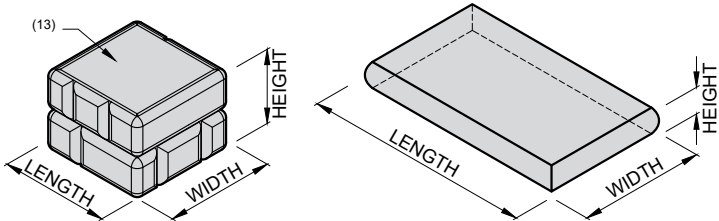

COLUMN BLOCK

CAP/ STEP BLOCK

DIMENSIONAL TOLERANCES ⁽¹¹⁾⁽¹²⁾

	COLUMN BLOCKS	CAP/ STEP BLOCKS
HEIGHT	18 ± 3/16 (457 ± 5)	6 ± 3/16 (152 ± 5)
LENGTH	24 ± 1/2 (610 ± 13)	VARIES ± 1/2 (VARIES ± 13)
WIDTH	24 ± 1/2 (610 ± 13)	28 1/2 ± 1/2 (724 ± 13)

⁽¹⁾ Concrete mix properties are in general accordance with ACI 318 durability requirements. Research has shown that concrete manufactured to these standards demonstrates good durability and performance. When these requirements are followed, specific freeze-thaw testing of the concrete is typically NOT required.

⁽²⁾ Exposure class is as described in ACI 318.

⁽³⁾ Test method ASTM C39.

⁽⁴⁾ Defined in ASTM C33 Table 3 *Limits for Deleterious Substances and Physical Property Requirements of Coarse Aggregate for Concrete*.

⁽⁵⁾ Test method ASTM C231.

⁽⁶⁾ Test method ASTM C1218 at age between 28 and 42 days.

⁽⁷⁾ Where used in high sulfate environments or where alkali-silica reactivity is and issue, watesoluble chloride shall be limited to no more than trace amounts (from impurities in concrete-making components, not intended constituents.)

⁽⁸⁾ The total cementitious material also includes ASTM C150, C595, C845, and C1157 cement. The maximum percentages shall include:

(a) Fly ash or other pozzolans in type IP, blended cement, ASTM C595, or ASTM C1157.

(b) Slag used in the manufacture of an IS blended cement, ASTM C595, or ASTM C1157.

(c) Silica fume, ASTM C1240, present in a blended cement.

⁽⁹⁾ Fly ash or other pozzolans and silica fume shall constitute no more than 25 and 10 percent, respectively, of the total weight of the cementitious materials.

⁽¹⁰⁾ Prescriptive limits shown may be waived for concrete mixes that demonstrate excellent freeze-thaw durability in a detailed and current testing program.

⁽¹¹⁾ All dimensions are shown in units of *inches (mm)*.

⁽¹²⁾ Permissible defects: Chips smaller than 1.5" (38mm) in its largest dimension and cracks not wider than 0.012" (0.305mm) and not longer than 25% of the nominal height of the block; bug holes in the architectural face smaller than 0.75" (19mm); and bug holes, water marks, and color variation on non-architectural faces.

⁽¹³⁾ Column blocks have a smooth troweled finish on horizontal faces.

ACCESSORIES (CAP AND STEP BLOCKS)

Block Library

A-2SC TWO-SIDED	A-4SC FOUR-SIDED
Block Weight: 630 lb (290 kg)	Block Weight: 670 lb (300 kg)
Block Volume: 4.42 ft³ (0.125 m³)	Block Volume: 4.65 ft³ (0.132 m³)

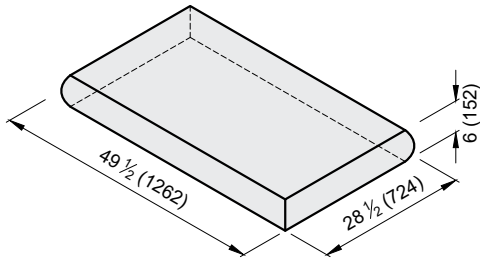
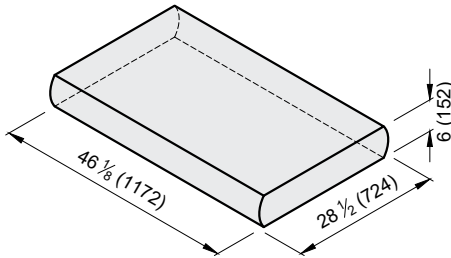

A-3SC72 THREE-SIDED 72"
Block Weight: 1040 lb (470 kg)
Block Volume: 7.3 ft³ (0.21 m³)

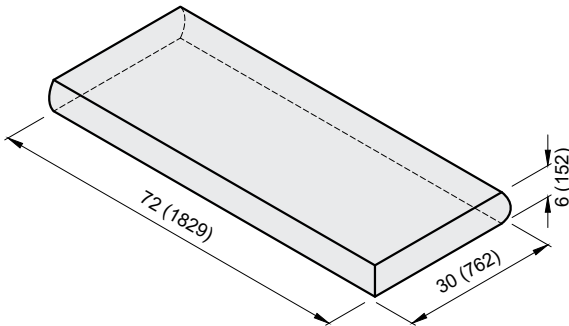

1. Units for dimensions are inches (mm), typical unless noted otherwise.

2. Block production varies with each licensed Redi-Rock manufacturer. Confirm availability before Specifying or Ordering.
3. Actual block volumes and weights may vary.

4. Weights are based upon a concrete density of 143 lb/ft³ (2291 kg/m³).

ACCESSORIES (COLUMN BLOCKS)

Block Library

A-COL8 COLUMN - 8" (203mm) CORE	A-COL4 COLUMN - 4" (102mm) CORE
Block Weight: 730 lb (330 kg)	Block Weight: 810 lb (370 kg)
Block Volume: 5.1 ft³ (0.14 m³)	Block Volume: 5.6 ft³ (0.16 m³)

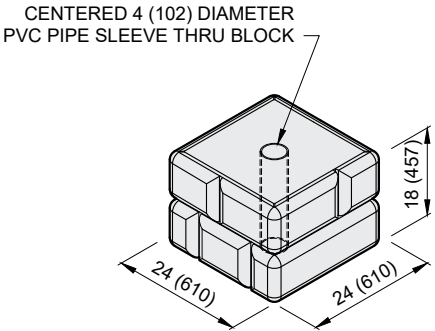
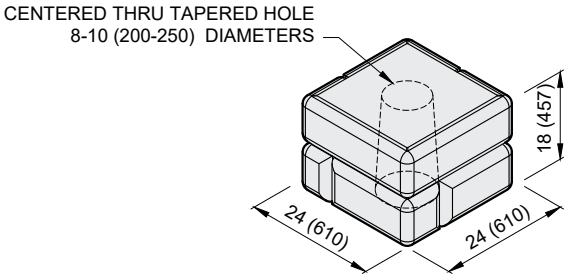

A-COLS COLUMN - SOLID CORE	A-CC COLUMN CAP
Block Weight: 830 lb (380 kg)	Block Weight: 390 lb (180 kg)
Block Volume: 5.8 ft³ (0.16 m³)	Block Volume: 2.7 ft³ (0.08 m³)

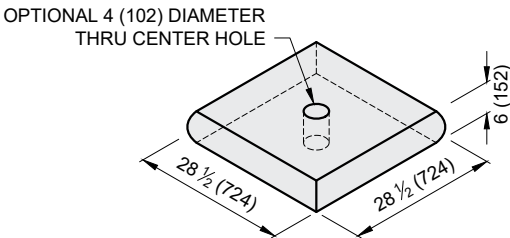
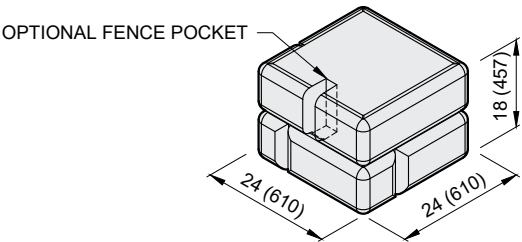

1. Units for dimensions are inches (mm), typical unless noted otherwise.

2. Block production varies with each licensed Redi-Rock manufacturer. Confirm availability before Specifying or Ordering.

3. Actual block volumes and weights may vary.
4. Weights are based upon a concrete density of 143 lb/ft³ (2291 kg/m³).

5. Weight and volume ranges represents the blocks with the maximum hole size shown and with no hole.

6. Optional fence rail pockets available upon request. Typical pocket size is: 2 (50) wide x 5 (130) deep x 9 (230) tall.