

TYPE "E-R1" LIGHT FIXTURE
& CONCRETE BASE DETAIL

NO SCALE
PROVIDE FLUSH GRADE JUNCTION BOX AT BASE OF POLE, AS REQUIRED.

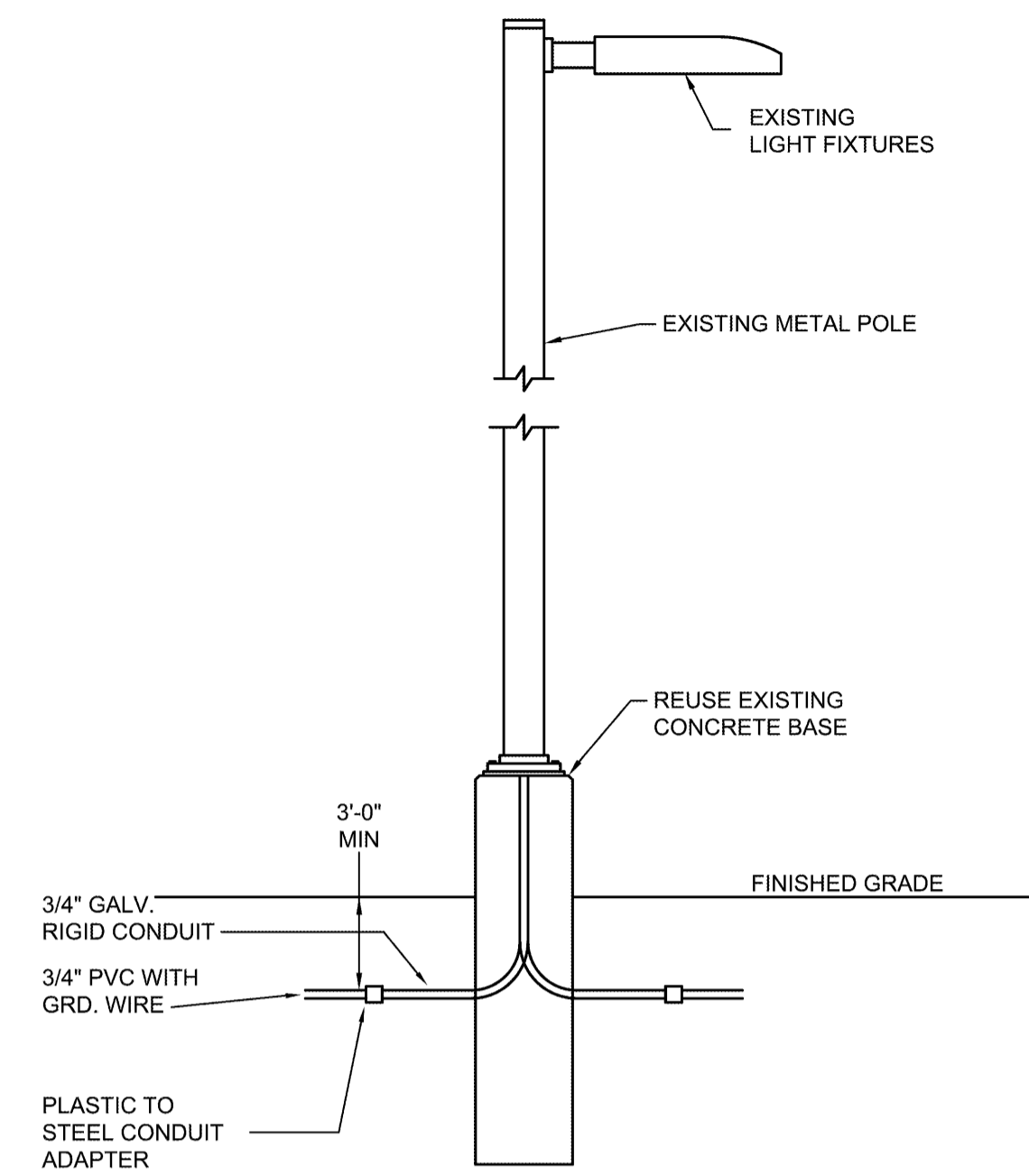

TYPE "SL2" LIGHT FIXTURE
& CONCRETE BASE DETAIL

NO SCALE
PROVIDE FLUSH GRADE JUNCTION BOX AT BASE OF POLE, AS REQUIRED.

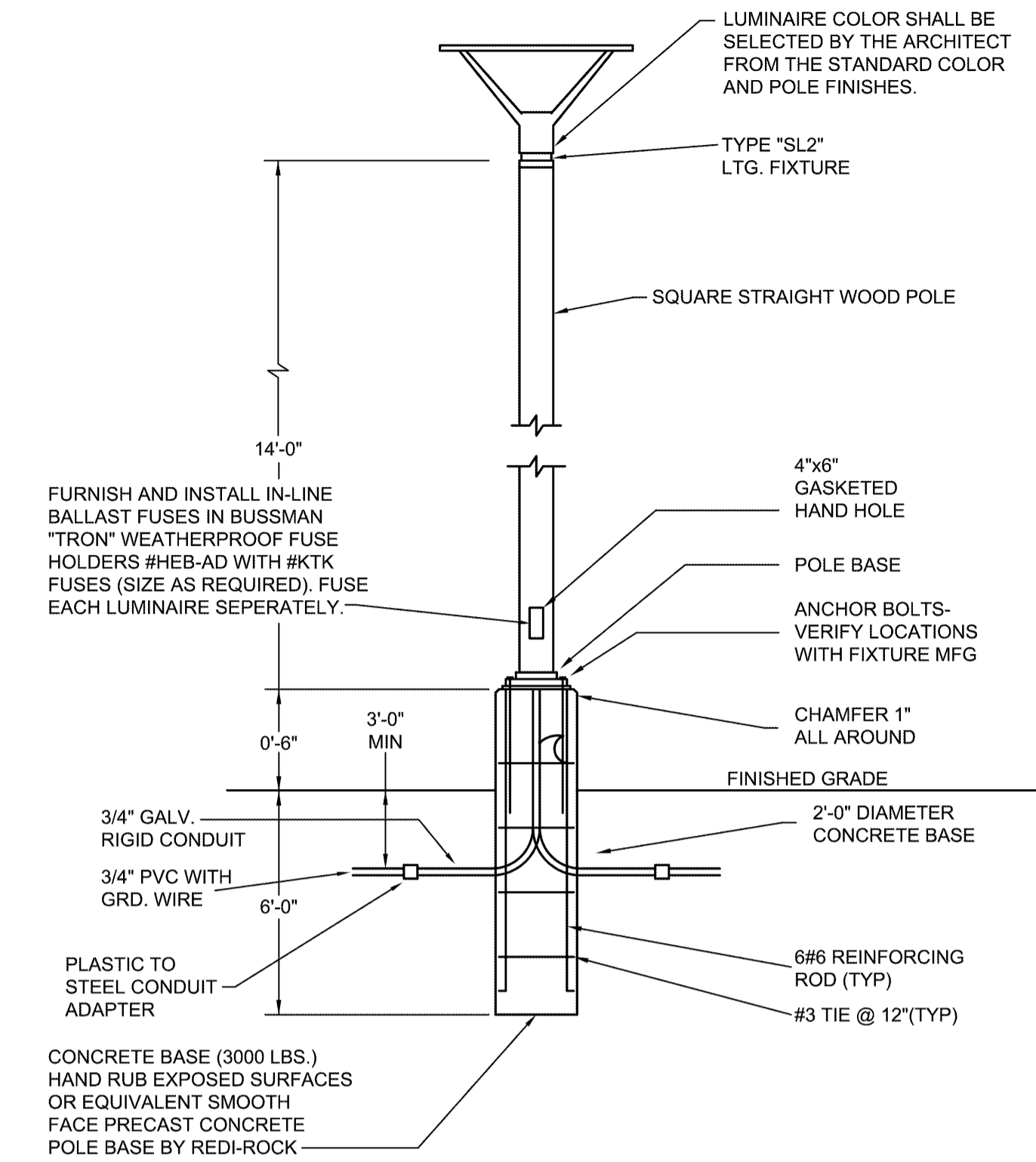

TYPE "E-R" LIGHT FIXTURE
& CONCRETE BASE DETAIL

NO SCALE
PROVIDE FLUSH GRADE JUNCTION BOX AT BASE OF POLE, AS REQUIRED.

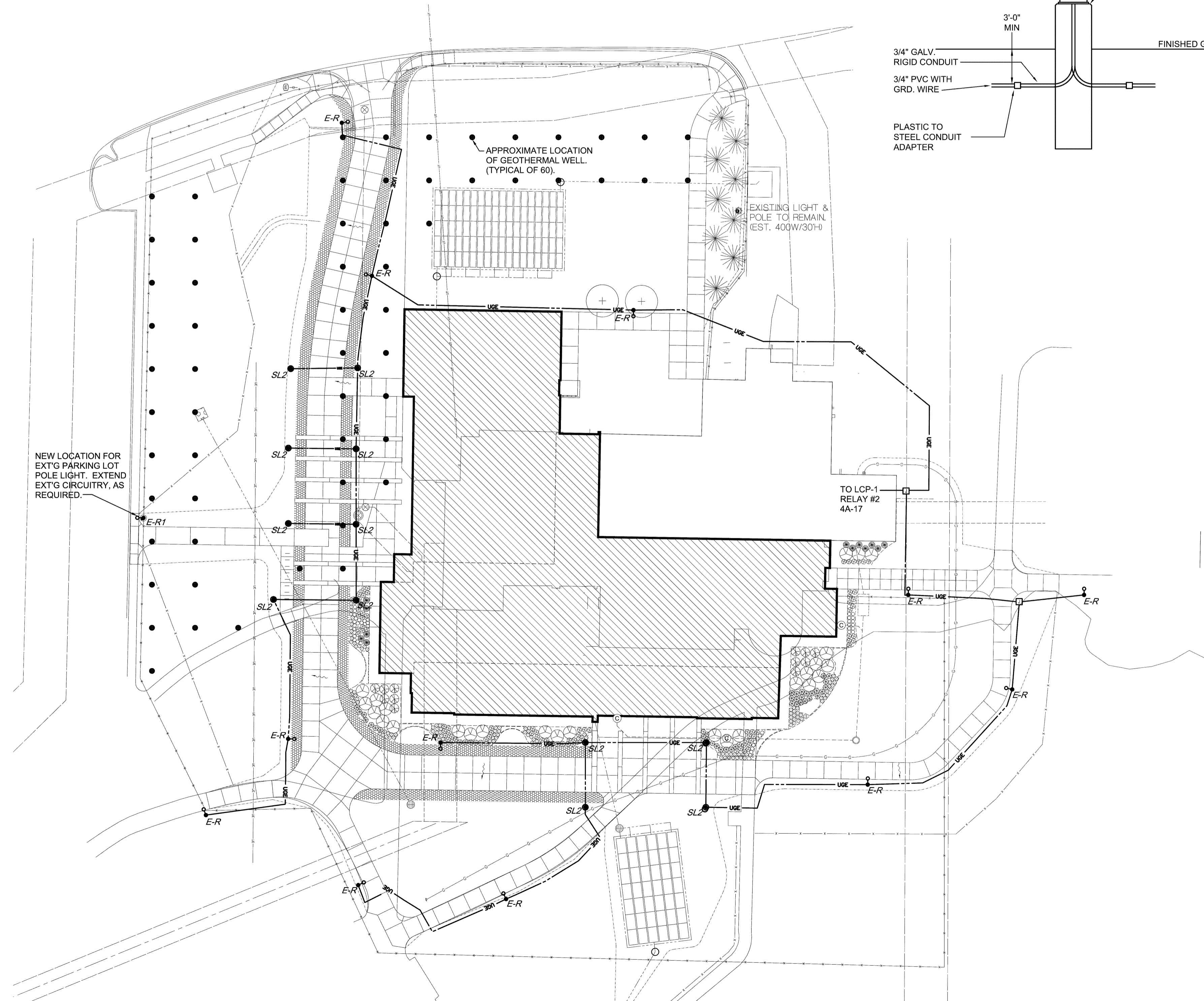
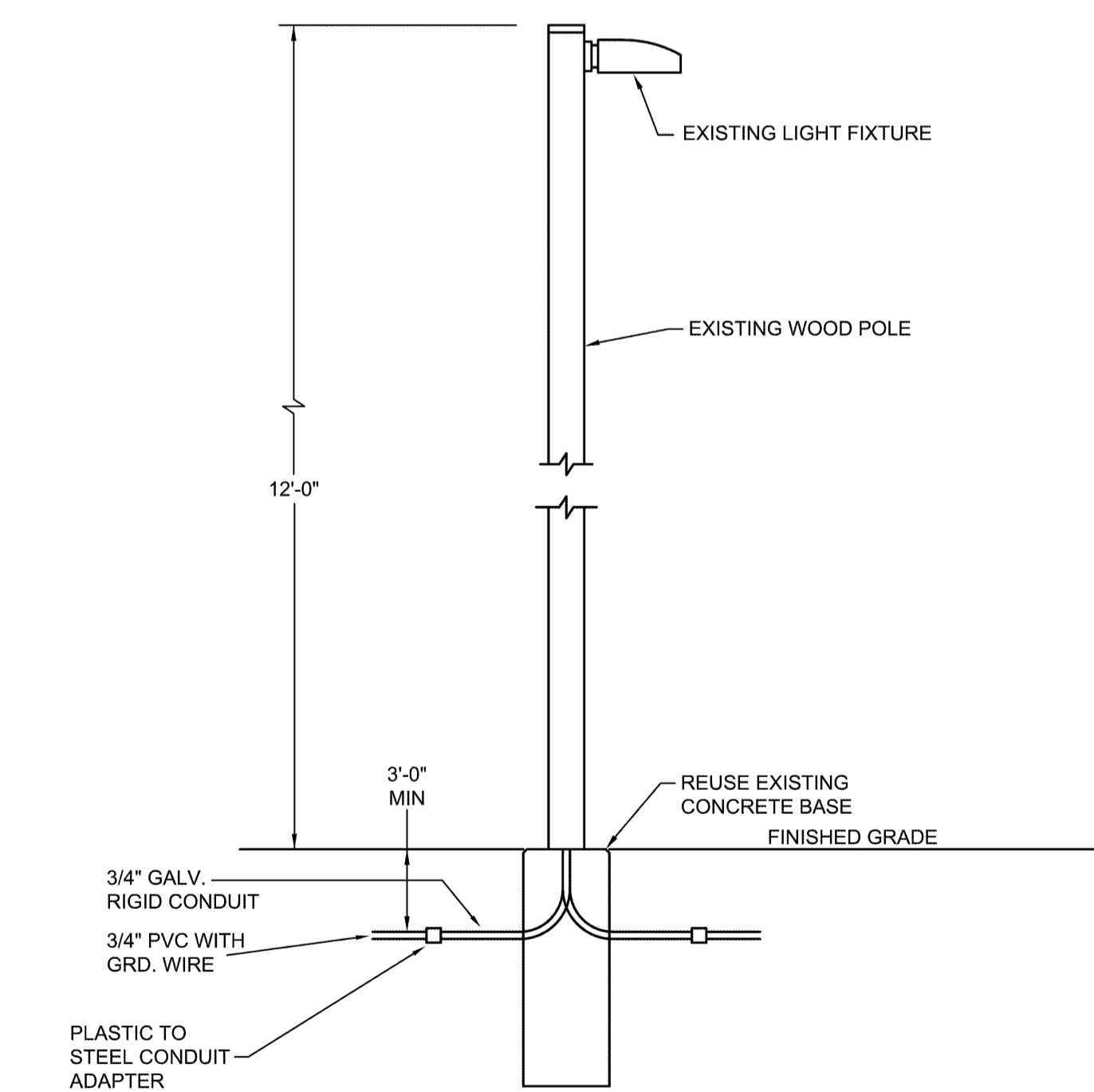

Electrical Lighting Site Plan
SCALE: 1" = 30'-0"

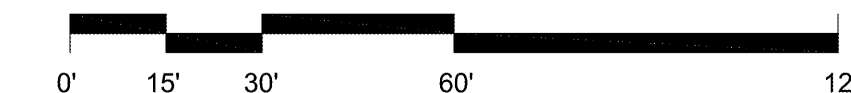

NOTE:
E.C. TO REINSTALL EXISTING POLES
AND FIXTURES PROVIDED BY OWNER IN
THE LOCATIONS SHOWN ON THE SITE
PLAN.

811 Know what's below.
Call before you dig.

THE LOCATION OF THE EXISTING UTILITIES, AS SHOWN ON THIS
PLAN, ARE APPROXIMATE ONLY. IT SHALL BE THE RESPONSIBILITY
OF THE CONTRACTOR TO VERIFY ACTUAL LOCATION AND DEPTH OF
ALL EXISTING UTILITIES. THE OWNER AND THE SURVEYOR SHALL
NOT BE RESPONSIBLE FOR ANY OMISSION OR VARIATION FROM THE
LOCATION SHOWN. THE CONTRACTOR SHALL NOTIFY "MISS DIG" AT
(800) 482-7171 OR 911 THREE (3) WORKING DAYS PRIOR TO THE
START OF CONSTRUCTION.

338 Cornerstone Dr., Suite 102
Traverse City, MI 49684
P 231.933.2177 F 231.933.4310
www.cornerstone-arch.com

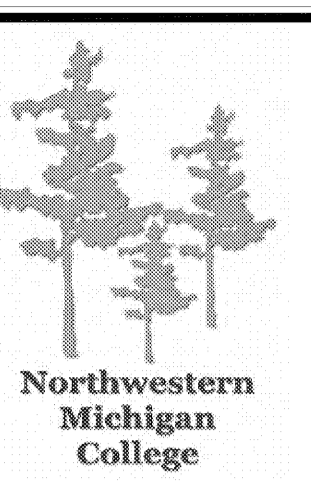
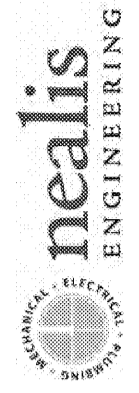

**WEST HALL INNOVATION CENTER
RENOVATION & EXPANSION**
DTMB File No. 332/16282
Northwestern Michigan College
1861 College Drive, Traverse City, MI

© copyright - all rights reserved. These drawings remain the property of cornerstone architects, inc. and are for use authorized by the architect only.

Cornerstone Architects
Traverse City - Grand Rapids
Architecture Interior Design Historic Preservation
122 S. Union, Suite 200
231.947.2177 P www.cornerstone-arch.com 231.933.4310 F

DATE	ISSUED FOR
04.20.18	DD Progress Set
04.30.18	Review
05.07.18	90% DD Set
05.14.18	DTMB Phase 400
07.16.18	50% Bid Pack #3
08.10.18	50% Cost Estimate
08.17.18	60% Bid Pack #3
09.24.18	Plan Review
11.21.18	Bid Pack #3-CM
12.12.18	Bid Pack #3

PC: JED
PM: JAV
DRAFTS: JAV

PROJECT NO:
18.501

SHEET TITLE:
Electrical Lighting
Site Plan

SHEET NO:
SE201