

0" 3" 6" 9" 12"
SCALE

TOP VIEW

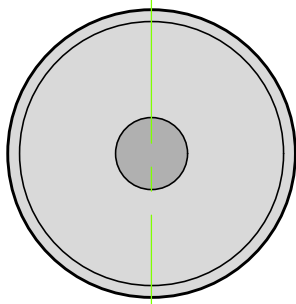

HORIZONTAL SECTION

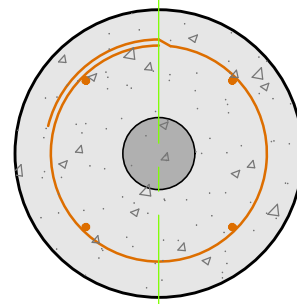

BOLLARD

STEEL REINFORCING

BACKFILL MATERIAL.
COMPACT PER SPECS.

GROUND SURFACE

GRADE LINE

EXPOSED BOLLARD HEIGHT

SIDE VIEW -
INSTALLATION

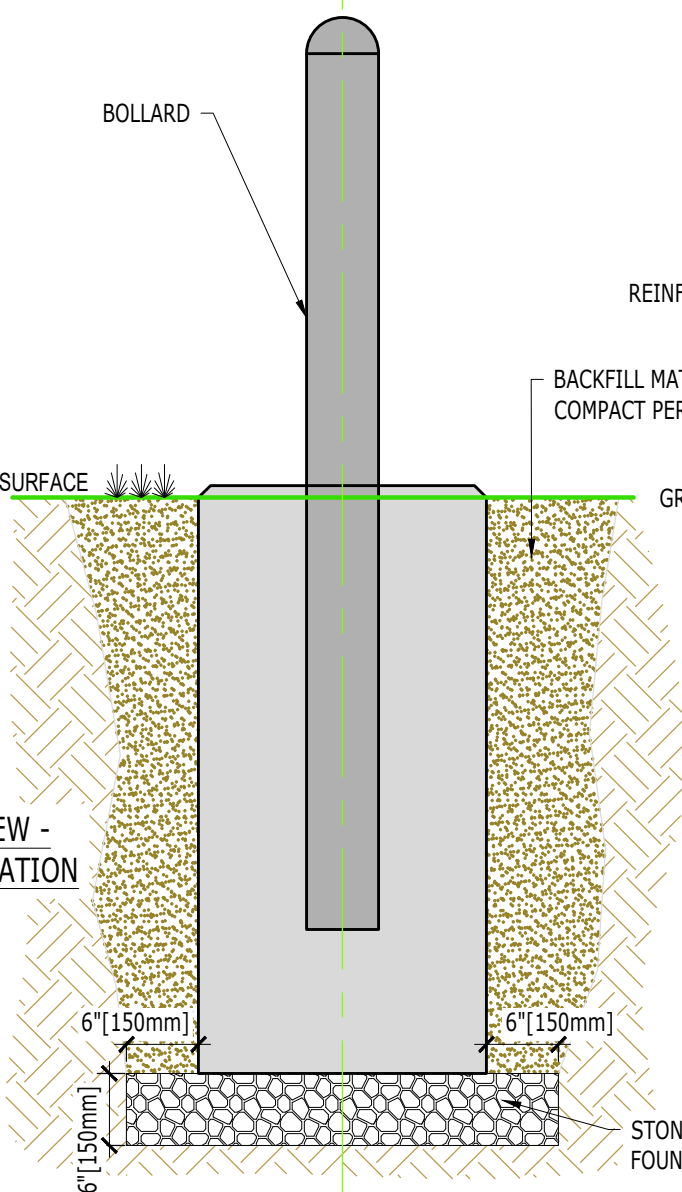

BURY DEPTH PER DESIGN

VERTICAL SECTION

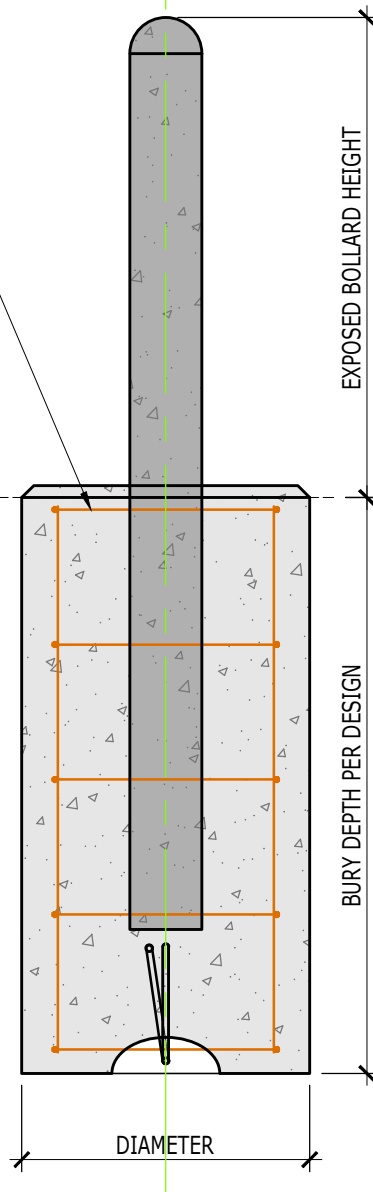

DIAMETER

NOTES:

1. STEEL REINFORCEMENT PER SITE DESIGN. 18 IN [457 MM], 24 IN [610 MM], AND 30 IN [762 MM] BASES AVAILABLE.
2. BOLLARD TYPICALLY 6 IN [150 MM] DIA. GALVANIZED PIPE W/ CONCRETE FILL. 4 IN [102 MM] AND 8 IN [203 MM] BOLLARDS ALSO POSSIBLE.

DRAWN BY:	LBH
SCALE:	3/4" = 1'-0"
DATE:	01/16/2023
SHEET:	1 of 1

TITLE:	POLE BASE PRECAST BOLLARD
FILE:	Pole_Base_Precast_Bollard

pole base
3890 CHARLEVOIX AVE. PETOSKEY, MI 49720
866-222-8400 • www.polebase.com