

inviting, enhancing, enduring
www.discoverrosetta.com

The OUTCROPPING *Freestanding System*

FEATURES

- Same **beautiful** weathered stone textures found on our outcropping units.
- A five sided surface texture allows for free standing (2-sided) installations.
- Optional cored units allow for grouting and rebar installation for **high heights**.
- Consistent dimensions = **fast installation**.



TYPICAL FREESTANDING WALL

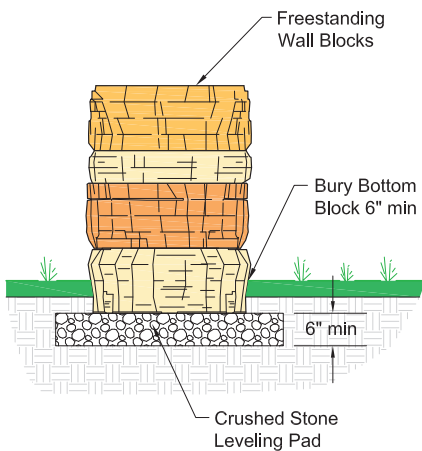

PALLET "D" FREESTANDING BLOCKS

11 sqft wall per pallet | pallet weight = 3130 lbs

12" x 5' Block
Length: 5'
Width: Approx 30"
Height: 12"
Weight: 1,540 lbs



12" x 4' Block
Length: 4'
Width: Approx 30"
Height: 12"
Weight: 1,080 lbs



6" x 4' Block
Length: 4'
Width: Approx 30"
Height: 6"
Weight: 460 lbs



PALLET "E" FREESTANDING BLOCKS

10.5 sqft wall per pallet | pallet weight = 3450 lbs

12" x 6' Block
Length: 6'
Width: Approx 30"
Height: 12"
Weight: 2,080 lbs



12" x 3' Block
Length: 3'
Width: Approx 30"
Height: 12"
Weight: 880 lbs



6" x 3' Block
Length: 3'
Width: Approx 30"
Height: 6"
Weight: 440 lbs



TYPICAL GROUTED WALL SECTION

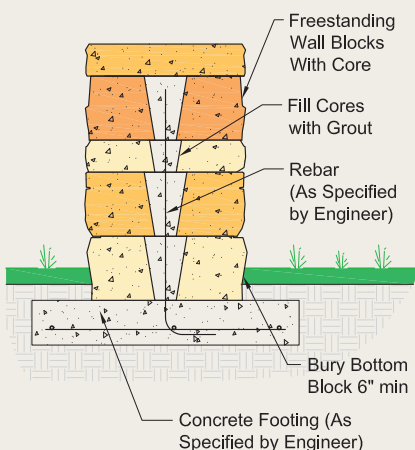

PALLET "D" BLOCKS (WITH CORE)

11 sqft wall per pallet | pallet weight = 2700 lbs

12" x 5' Block
Length: 5'
Width: Approx 30"
Height: 12"
Weight: 1,360 lbs



12" x 4' Block
Length: 4'
Width: Approx 30"
Height: 12"
Weight: 840 lbs



6" x 4' Block
Length: 4'
Width: Approx 30"
Height: 6"
Weight: 460 lbs



PALLET "E" BLOCKS (WITH CORE)

10.5 sqft wall per pallet | pallet weight = 2950 lbs

12" x 6' Block
Length: 6'
Width: Approx 30"
Height: 12"
Weight: 1,720 lbs



12" x 3' Block
Length: 3'
Width: Approx 30"
Height: 12"
Weight: 760 lbs



6" x 3' Block
Length: 3'
Width: Approx 30"
Height: 6"
Weight: 420 lbs

